

HC-DMU-W (4G) DATA MANAGEMENT UNIT QUICK INSTALLATION GUIDE

1 Interface Layout

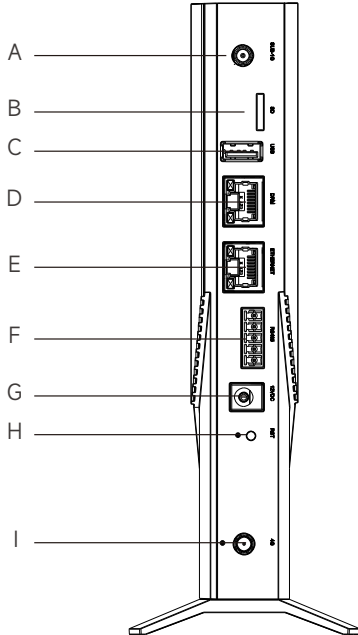

WIFI Module (Model: HC-DMU-W)

No.	Description
A	Sub-1G antenna
B	SD card slot
C	USB port (Software upgrades only)
D	DRM port
E	Ethernet port
F	RS485
G	Power port
H	Reset button
I	WIFI antenna

NOTES

WIFI & Sub-1G antenna has been integrated. If the signal is weak due to the installation environment, an extra antenna can be purchased and connected.

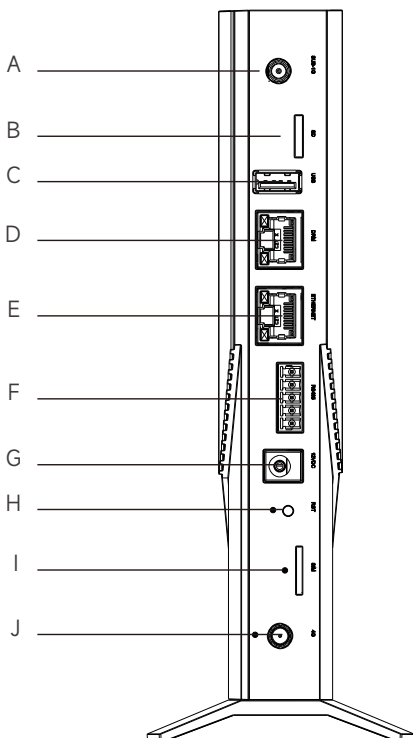

4G Module (Model: HC-DMU-4G)

No.	Description
A	Sub-1G antenna
B	SD card slot
C	USB port (Software upgrades only)
D	DRM port
E	Ethernet port
F	RS485
G	Power port
H	Reset button
I	SIM card slot
J	4G antenna

NOTES

WIFI & Sub-1G antenna has been integrated. If the signal is weak due to the installation environment, an extra antenna can be purchased and connected.

2 LED Indicator Panel

The LED indicator is used as a human-computer interaction interface to indicate the current working status of the DMU.

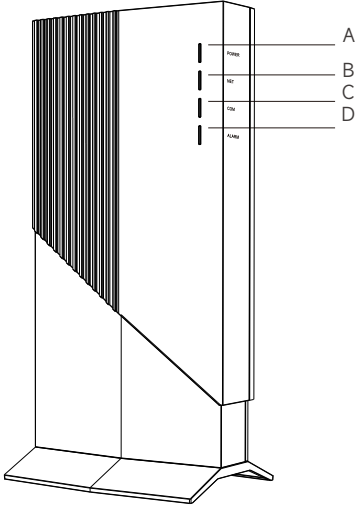

No.	Description	LED status	Device status
A	Power indicator	ON	Power on
		OFF	Power off
B	Network communication (connecting to the server)	Solid	Normal
		Flashing	Abnormal
C	Microinverter communication (connecting to microinverter)	Solid	Normal
		Flashing	Abnormal
D	Fault condition	ON	Abnormal
		OFF	Normal

3 Installation Materials

Name	Quantity	Unit
Power adapter	1	Set
Green terminal	1	PC
Installation map	1	PC
Quick installation guide	1	PC
Fixed base	1	PC
Mount	1	PC
Screws	1	Set
M6*50 expansion screw	4	PC
ST3.5*9.5 Cross tapping screws	2	PC
ST4.8*16 Cross tapping screws	2	PC

NOTES

The above materials are included with the product.

4 Installation

4.1 Installation Environment Requirements

- Standard AC power sockets available on site.
- Router/LAN/4G network with Ethernet interface available on site.
- Keep away from dust, liquids, acidic or corrosive gases.
- Environmental temperature -20 to +55°C.
- It is prohibited to install the product in a location that can be reached by children.

4.2 Connect to a Network

4.2.1 4G Module (Model: HC-DMU-4G)

- Step 1: Using 4G: Insert the SIM card into the SIM card slot on the side of the DMU until you hear a sound of "click".
- Step 2: Using wired network: Plug one end of the network cable into the Ethernet port of the DMU

and the other end into the broadband router port.

NOTES

Just choose one between 4G network and wired network.

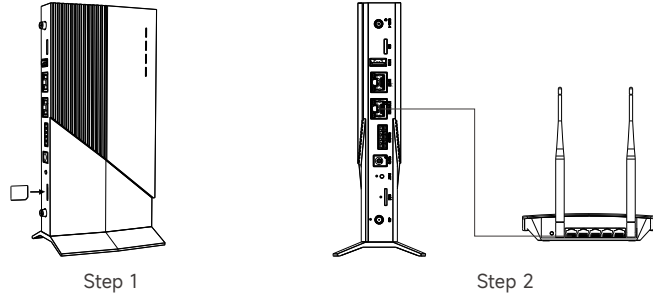

4.2.2 WIFI Module (Model: HC-DMU-W)

- Step 1: Using WIFI: Scan QR Code in Chapter 5, follow the guide to finish the WIFI configuration.
- Step 2: Using wired network: Plug one end of the network cable into the Ethernet port of the DMU and the other end into the broadband router port.

NOTES

Just choose one between WIFI network and wired network.

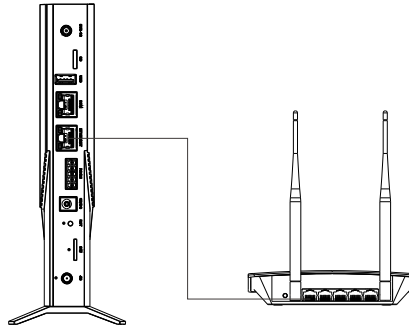

4.3 Choose Install Location

- On the roof can increase the signal strength.
- In the center of the PV array.
- At least 0.5m from the ground and at least 0.8m from corners.

4.4 Installation Method

4.4.1 Desktop Installation Put the DMU on the table

- Step 1: Use special screws to connect the base fixture with the DMU device and place it vertically on the table.
- Step 2: Configure the system after connecting the power supply and the network.

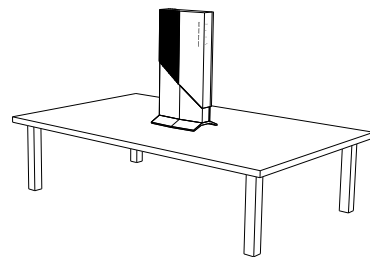

4.4.2 Wall-mounted Method

- Step 1: Hang the mount on the wall, adjust the angle, and mark it with a marker pen.
- Step 2: Use a drill bit of the corresponding specifications to drill holes at the mark.
- Step 3: Align the mount with the hole, and put the expansion screw through the hanging plate into the hole to fix it.
- Step 4: Use special screws to connect the base with the DMU device.
- Step 5: Fix the installed device on the mount with the supplied screws.
- Step 6: Configure the system after connecting the power supply and the network.

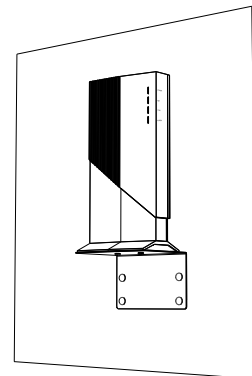

NOTES

You need to prepare yourself: marker pens, electric drills, screwdrivers and other tools.

4.5 Installation Map

Peel off the serial number label from the DMU and attach it to the installation map.

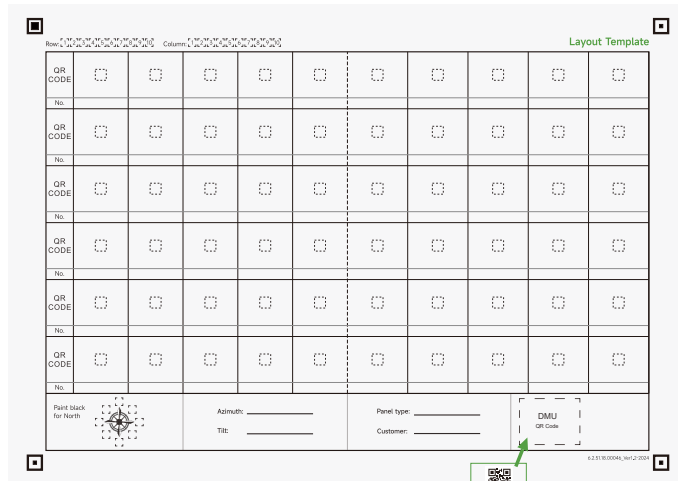
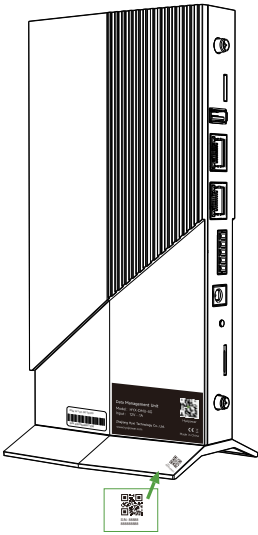

5 System Commissioning

5.1 Installing the App

Method 1

Download the "XiPOWER APP" from the app store:

- App Store (IOS)
- Google Play

Method 2

Scan the QR code and download the APP:



App Download

5.2 APP Quick Guide

For more information on using the XiPOWER APP, please scan the QR code.

Web: <https://hiitio-or.xipowercloud.com>

NOTES

For more details on "Zero Export Management", please obtain the user manual from the official website or technical department of XiPOWER.

6 Warning

- Only qualified personnel can install or replace the DMU. Do not attempt to repair the DMU as it contains the parts that are not serviceable to users.
- If the DMU breaks down, please contact your distributor for maintenance.
- Opening the DMU without permission will invalidate the warranty.