

# HITIO<sup>®</sup>

## 和诚电气



HIGH VOLTAGE DC CONTACTOR PRODUCT CATALOGUE

高压直流接触器产品样册

浙江和诚智能电气有限公司

ZHEJIANG HECHENG SMART ELECTRIC CO., LTD.

**High-voltage DC electrical suppliers used  
by the world's top 500**





# HIITIO

浙江和诚智能电气有限公司(以下简称和诚电气)成立于2004年,现公司总部坐落于浙江省杭州市萧山区经济技术开发区知行路1125号,总部基地建筑面积30000m<sup>2</sup>。作为全球领先的新能源行业以及工业控制解决方案供应商,目前和诚电气的另一大生产基地设在安徽明光,其中工厂占地53000m<sup>2</sup>,厂房占地20000m<sup>2</sup>。和诚电气专注于新能源汽车、光伏、储能以及HVAC/R行业、工业控制领域等,主要研发、生产和经营的产品有:陶瓷高压直流继电器/接触器,高压直流熔断器,空调接触器,IEC接触器,UL489断路器和隔离开关盒等,和诚电气产品均通过UL, CSA, INTERTEK, CE, CCC等认证。

和诚电气注重产品研发,公司每年营收的10%用于研发投入,2%用于IT投入,目前具备10年以上行业内工作经验的研发人员占比高达35%。

此外,和诚电气新引进先进的自动化生产线和先进的实验室检测设备,全流程严格执行IATF16949体系,PLM+ERP+MES实现工厂数字化、智能化,研发生产销售做到全过程可追溯溯源。

Zhejiang Hecheng Smart Electric Co, Ltd. (referred to as Hecheng Electric) was established in 2004 and is now headquartered at No.1125, Zhixing Road, Xiaoshan Economic and Technological Development Zone, Hangzhou City Zhejiang Province. Hecheng headquarters base 30000 square meters. Hecheng is a leading supplier of new energy industry and industrial control solutions in the world. At present, another large production base of Hecheng Electric is located in Mingguang, Anhui Province, with an area of 14 acres and a plant area of 20000 square meters. Hecheng Electric focuses on new energy vehicles, photovoltaic, energy storage, HVAC/R, industrial control, etc. Hecheng's main R&D production and operation products include: ceramic high-voltage DC relay/contactor, high-voltage DC fuse, airconditioning contactor, IEC contactor, UL 489 circuit breaker and disconnect box, etc. Hecheng's products all have passed UL, CSA, INTERTEK CE, CCC and other certifications.

Hecheng Electric aims at product research and development, 10% of the company's annual revenue is spent on R&D and 2% on IT penetration. Currently, the proportion of R&D personnel with more than 10 years of working experience in the industry is as high as 35%.

In addition, Hecheng Electric has introduced advanced automatic production lines and advanced laboratory testing equipment. We strictly implemented the IATF16949 system in the whole process. PLM + ERP + MES technology realizes the digitalization and intellectualization of the factory. The whole process of R&D, production and sales is able to be traced.



# APPLICATION

# AREA 应用领域

新能源汽车  
New Energy Vehicle

储能  
Energy Storage

风电  
Wind Power

光伏  
Photovoltaic

充电桩、换电站  
Charging Pile、 Changing Station





世界500强  
都在用的  
高压直流电气  
供应商

HIITIO<sup>®</sup>  
和诚电气

# 产品介绍 PRODUCT INTRODUCTION

## 直流接触器 DC CONTACTORS



### 特性 Features:

- 陶瓷密封结构，腔体充有特殊混合气体，无电弧泄露风险，接触电阻低且稳定；  
Ceramic sealing internal design, filled with special mixed gas; No risk of arc leakage; Low & stable contact resistance;
- 良好的抗短路能力，确保通过短路电流，触头仍能可靠闭合不斥开，产品不起火不爆炸；  
High value of short-circuit current withstanding to ensure the contacts can be reliably closed when encountering short-circuit current, contributing to no risk of fire and explosion;
- 无极性灭弧设计，安装方向不敏感，适用回路双向电流的各种场景，使用安全可靠；  
Non-polarity arc extinguishing design that is applicable to a range of scenarios with bidirectional current circuit safely and reliably;
- 全系列产品满足1000VDC电压平台要求，部分系列产品满足1500VDC和2000VDC电压平台要求；  
The whole series of HVDC contactors are able to work under rated 1000Vdc, and part of them reach 1500VDC and 2000VDC;
- 产品符合RoHS、REACH要求；  
RoHS & REACH compliant;

### 产品型号 Product Model

	H	C	F	40	□	/	450	-	12	H	C	1	□	□	-	()
HC 公司代码 Company Code																
系列代码 Series Code	F: 方形系列 Square Series															
触点容量 (额定电流) Contact Rating (Rated Current)	20:20A;40:40A;60:60A;100:100A;150:150A;200:200A;250:250A;300:300A;350:350A;400:400A;500:500A;600:600A;700:700A;800:800A;1000:1000A;															
衍生型号 Derivative Model	无Nil:基本型Basic Model ; A/B/C/D/E:衍生型Derivative Model															
负载电压 Load Voltage	450: 450VDC; 800: 800VDC; 1000: 1000VDC; 1500: 1500VDC															
线圈电压 Coil Voltage	12: 12VDC; 24: 24VDC; 48: 48VDC															
主触点形式 Main Contact Type	H: 一组常开 SPST-NO															
线圈出线方式 Coil Input Terminal	L: 引出线 Lead Wire; C: 连接器 Connector; E: 引出线+连接器 Lead Wire + Connector Q: QC引出端 Terminal; P: PCB引出端 Terminal;															
负载引出端方式 Load Input Terminal	1: 内螺纹 Internal Thread; 2: 外螺纹 External thread (仅HCF600系列 Only HCF600 series) 3: QC引出端 Terminal; 4: PCB引出端 Terminal; 5: 铜排 Copper Busbar															
辅助触点 Auxiliary Contact	无 Nil: 无辅助触点 No Auxiliary Contact; H: 一组常开 SPST-NO C: 一组常闭 SPST-NC; Z: 一组常开&一组常闭 SPST-NO&SPST-NC															
安装形式 Mounting	无 Nil: 立式安装 Vertical Mounting; B: 无安装脚 No Mounting U: U型安装脚 U-Shaped Mounting; Y: 卧式安装 Horizontal installation															
特性号 Special Code	XXX: 客户特殊要求 Customer Special Code; 无 Nil: 标准性 Standard															

## 特性参数 CHARACTERISTIC PARAMETER

产品型号	HCF20	HCF40
产品图片		

### 主触点参数 MAIN CONTACT DATA

最大工作电压 Max. Switching Voltage	800VDC	1500VDC
额定电流 Rated Current	20A	40A
触点形式 Contact Arrangement	一组常开 SPST-NO	一组常开 SPST-NO
触点压降 Contact Voltage Drop	≤0.3V(at 20A)	≤0.12V (at 40A)
短时承载电流 Limiting Short-time Current	40A:30min; 80A:30s; 120A:10s	60A:120min; 80A:20min; 160A:30s; 320A:2s; 400A:0.6s
电寿命 (阻性负载) Electrical Life(Resistive Load)	10A 450VDC 10000次(ops) 20A 450VDC 3000次(ops) 20A 450VDC 75000次(ops) 仅接通Only Making 6A 800VDC 75000次(ops) 仅接通Only Making	40A 450VDC 20000次(ops) 40A 800VDC 3000次(ops) 40A 1000VDC 800次(ops) 15A 1500VDC 10000次(ops) 40A 1500VDC 15000次(ops) 仅接通 Only Making
最大分断电流(阻性负载) Max. Breaking Current(Resistive Load)	/	400A 450VDC 1次(ops)
过载分断(阻性负载) Overload Breaking(Resistive Load)	/	120A 450VDC 30次(ops)

### 辅助触点参数 AUXILIARY CONTACT DATA

辅助触点 Auxiliary Contact	无 Nil	无 Nil
辅助触点形式 Auxiliary Contact Arrangement	/	/
辅助触点电流范围 Auxiliary Contact Current Range	/	/

### 线圈参数 COIL DATA

额定电压 Rated Voltage	12VDC	24VDC	12VDC	24VDC	48VDC
吸合电压 Pick-up Voltage	≤9VDC	≤18VDC	≤9VDC	≤18VDC	≤36VDC
释放电压 Drop-out Voltage	≥1VDC	≥2VDC	≥1.2VDC	≥2.4VDC	≥4.8VDC
线圈功率 Rated Operating Power	约 Approx 3W	约 Approx 3W	约 Approx 3W	约 Approx 3W	约 Approx 3W
最大允许电压 Max. Allowable Voltage	16VDC	32VDC	16VDC	32VDC	64VDC

### 性能参数 CHARACTERISTICS DATA

介质耐压 Dielectric Strength	触点与线圈间 Between Contacts And Coil 断开触点间 Between Open Contacts	3000VAC 1min 2500VAC 1min	4000VAC 1min 3000VAC 1min
绝缘电阻 Insulation Resistance	触点与线圈间 Between Contacts And Coil 断开触点间 Between Open Contacts	1000MΩ(500VDC) 1000MΩ(500VDC)	1000MΩ(1000VDC) 1000MΩ(1000VDC)
耐冲击 Shock Resistance	功能性 Functional 强度 Destructive	20G 半正弦波 Half-Sine Wave 11ms 50G 半正弦波 Half-Sine Wave 6ms	20G 半正弦波 Half-Sine Wave 11ms 50G 半正弦波 Half-Sine Wave 6ms
耐振动 Vibration Resistance	功能性 Functional	49m/s <sup>2</sup> (10~500Hz)	5.79G (10~2000Hz, 随机/Random)
吸合时间 Operate Time		Max:30ms	Max:30ms
释放时间 Release Time		Max:10ms	Max:10ms
机械寿命 Mechanical Life		2*10 <sup>5</sup> 次(ops)	2*10 <sup>5</sup> 次(ops)
重量 Weight		约 Approx 55g	约 Approx 155g

### 安全认证 INSTALLATION CERTIFICATION

认证范围 Scope of Certification	UL/CE/CB/SEMKO/CQC/CCC
--------------------------------	------------------------



## 特性参数 CHARACTERISTIC PARAMETER

产品型号	HCF40B	HCF60
产品图片		

## 主触点参数 MAIN CONTACT DATA

最大工作电压 Max. Switching Voltage	450VDC	1500VDC
额定电流 Rated Current	40A	60A
触点形式 Contact Arrangement	一组常开 SPST-NO	一组常开 SPST-NO
触点压降 Contact Voltage Drop	≤0.2V(at 20A)	≤0.12V (at 60A)
短时承载电流 Limiting Short-time Current	60A:1h; 80A:20min; 160A:30s; 240A:10s	90A:60min; 120A:20min; 240A:30s; 360A:2s; 600A:0.6s
电寿命 (阻性负载) Electrical Life(Resistive Load)	10A 450VDC 10000 次(ops) 40A 450VDC 1000 次(ops) 35A 450VDC 75000 次(ops),仅接通 Only Making	60A 450VDC 3000次(ops) 60A 800VDC 1000次(ops) 60A 1000VDC 500次(ops)
最大分断电流(阻性负载) Max. Breaking Current(Resistive Load)	/	600A 450VDC 1次(ops)
过载分断(阻性负载) Overload Breaking(Resistive Load)	/	200A 450VDC 100次(ops)

## 辅助触点参数 AUXILIARY CONTACT DATA

辅助触点 Auxiliary Contact	无 Nil	无 Nil
辅助触点形式 Auxiliary Contact Arrangement	/	/
辅助触点电流范围 Auxiliary Contact Current Range	/	/

## 线圈参数 COIL DATA

额定电压 Rated Voltage	12VDC	24VDC	12VDC	24VDC	48VDC
吸合电压 Pick-up Voltage	≤9VDC	≤18VDC	≤9VDC	≤18VDC	≤36VDC
释放电压 Drop-out Voltage	≥1VDC	≥2VDC	≥1.2VDC	≥2.4VDC	≥4.8VDC
线圈功率 Rated Operating Power	约 Approx 3W	约 Approx 3W	约 Approx 3W	约 Approx 3W	约 Approx 3W
最大允许电压 Max. Allowable Voltage	16VDC	32VDC	16VDC	32VDC	64VDC

## 性能参数 CHARACTERISTICS DATA

介质耐压 Dielectric Strength	触点与线圈间 Between Contacts And Coil	3000VAC 1min	4000VAC 1min
	断开触点间 Between Open Contacts	2500VAC 1min	3000VAC 1min
绝缘电阻 Insulation Resistance	触点与线圈间 Between Contacts And Coil	1000MΩ(500VDC)	1000MΩ(1000VDC)
	断开触点间 Between Open Contacts	1000MΩ(500VDC)	1000MΩ(1000VDC)
耐冲击 Shock Resistance	功能性 Functional	20G 半正弦波 Half-Sine Wave 11ms	20G 半正弦波 Half-Sine Wave 11ms
	强度 Destructive	50G 半正弦波 Half-Sine Wave 6ms	50G 半正弦波 Half-Sine Wave 6ms
耐振动 Vibration Resistance	功能性 Functional	49m/s <sup>2</sup> (10~500Hz)	5.79G (10~ 2000Hz, 随机Random)
	吸合时间 Operate Time	Max:30ms	Max:30ms
释放时间 Release Time	Max:10ms	Max:10ms	
机械寿命 Mechanical Life	2*10 <sup>5</sup> 次(ops)	2*10 <sup>5</sup> 次(ops)	
重量 Weight	约 Approx 55g	约 Approx 155g	

## 安全认证 INSTALLATION CERTIFICATION

认证范围 Scope of Certification	UL/CE/CB/SEMKO/CQC/CCC
--------------------------------	------------------------

## 特性参数 CHARACTERISTIC PARAMETER

产品型号	HCF100	HCF100B
产品图片		

### 主触点参数 MAIN CONTACT DATA

最大工作电压 Max. Switching Voltage	1500VDC	1500VDC
额定电流 Rated Current	100A	100A
触点形式 Contact Arrangement	一组常开 SPST-NO	一组常开 SPST-NO
触点压降 Contact Voltage Drop	≤0.1V (at 100A)	≤0.05V (at 100A)
短时承载电流 Limiting Short-time Current	120A:60min; 200A:5min; 400A:1min; 600A:15s; 1000A:0.6s	150A:120min; 200A:30min; 400A:60s; 1000A:1s
电寿命 (阻性负载) Electrical Life(Resistive Load)	100A 450VDC 1000次(ops) 100A 800VDC 500次(ops) 100A 1000VDC 200次(ops)	100A 450VDC 3000次(ops) 100A 800VDC 1000次(ops) 100A 1000VDC 500次(ops) , 仅分断 Only Breaking 15A 1500VDC 6000次(ops) 30A 1500VDC 11000次(ops) , 仅接通 Only Making
最大分断电流(阻性负载) Max. Breaking Current(Resistive Load)	600A 450VDC 1次(ops)	1000A 450VDC 1次(ops)
过载分断(阻性负载) Overload Breaking(Resistive Load)	200A 450VDC 100次(ops)	300A 450VDC 100次(ops)

### 辅助触点参数 AUXILIARY CONTACT DATA

辅助触点 Auxiliary Contact	无 Nil	可选配 Optional
辅助触点形式 Auxiliary Contact Arrangement	/	一组常开 SPST-NO
辅助触点电流范围 Auxiliary Contact Current Range	/	100mA/8VDC ~ 2A/30VDC

### 线圈参数 COIL DATA

额定电压 Rated Voltage	12VDC	24VDC	48VDC	12VDC	24VDC	48VDC
吸合电压 Pick-up Voltage	≤9VDC	≤18VDC	≤36VDC	≤9VDC	≤18VDC	≤36VDC
释放电压 Drop-out Voltage	≥1.2VDC	≥2.4VDC	≥4.8VDC	≥1.2VDC	≥2.4VDC	≥4.8VDC
线圈功率 Rated Operating Power	约 Approx 3W	约 Approx 3W	约 Approx 3W	约 Approx 6W	约 Approx 6W	约 Approx 6W
最大允许电压 Max. Allowable Voltage	16VDC	32VDC	64VDC	16VDC	32VDC	64VDC



### 性能参数 CHARACTERISTICS DATA

介质耐压 Dielectric Strength	触点与线圈间 Between Contacts And Coil	4000VAC 1min	4000VAC 1min
	断开触点间 Between Open Contacts	3000VAC 1min	3000VAC 1min
绝缘电阻 Insulation Resistance	触点与线圈间 Between Contacts And Coil	1000MΩ(1000VDC)	1000MΩ(1000VDC)
	断开触点间 Between Open Contacts	1000MΩ(1000VDC)	1000MΩ(1000VDC)
耐冲击 Shock Resistance	功能性 Functional	20G 半正弦波 Half-Sine Wave 11ms	20G 半正弦波 Half-Sine Wave 11ms
	强度 Destructive	50G 半正弦波 Half-Sine Wave 6ms	50G 半正弦波 Half-Sine Wave 6ms
耐振动 Vibration Resistance	功能性 Functional	5.79G (10~ 2000Hz, 随机Random)	5.79G (10~ 2000Hz, 随机Random)
	吸合时间 Operate Time	Max:30ms	Max:30ms
释放时间 Release Time	Max:10ms	Max:10ms	
机械寿命 Mechanical Life	2*10 <sup>5</sup> 次(ops)	2*10 <sup>5</sup> 次(ops)	
重量 Weight	约 Approx 155g	约 Approx 350g	

### 安全认证 INSTALLATION CERTIFICATION

认证范围 Scope of Certification	UL/CE/CB/SEMKO/CQC/CCC	UL/CE/CB/SEMKO/CQC/CCC
--------------------------------	------------------------	------------------------

## 特性参数 CHARACTERISTIC PARAMETER

产品型号	HCF150			HCF200		
产品图片						
<b>主触点参数 MAIN CONTACT DATA</b>						
最大工作电压 Max. Switching Voltage	1500VDC			1500VDC		
额定电流 Rated Current	150A			200A		
触点形式 Contact Arrangement	一组常开 SPST-NO			一组常开 SPST-NO		
触点压降 Contact Voltage Drop	≤0.075V (at 150A)			≤0.1V (at 200A)		
短时承载电流 Limiting Short-time Current	180A:120min; 225A:15min; 300A:2min; 600A:20s; 900A:8s; 1500A:0.6s			250A:15min; 320A:5min; 600A:30s; 900A:10s; 2000A:0.6s		
电寿命 (阻性负载) Electrical Life(Resistive Load)	150A 450VDC 3000次(ops) 150A 800VDC 1000次(ops) 150A 1000VDC 500次(ops) 仅接通Only Breaking 15A 1500VDC 6000次(ops) 30A 1500VDC 11000次(ops) 仅接通Only Making			200A 450VDC 1200次(ops) 200A 800VDC 500次(ops) 150A 1000VDC 500次(ops) 仅分断 Only Breaking 15A 1500VDC 6000次(ops) 30A 1500VDC 11000次(ops) 仅接通Only Making		
最大分断电流(阻性负载) Max. Breaking Current(Resistive Load)	1500A 450VDC 1次(ops)			2000A 450VDC 1次(ops)		
过载分断(阻性负载) Overload Breaking(Resistive Load)	300A 450VDC 100次(ops)			300A 450VDC 100次(ops)		
<b>辅助触点参数 AUXILIARY CONTACT DATA</b>						
辅助触点 Auxiliary Contact	可选配 Optional			可选配 Optional		
辅助触点形式 Auxiliary Contact Arrangement	一组常开 SPST-NO			一组常开 SPST-NO		
辅助触点电流范围 Auxiliary Contact Current Range	100mA/8VDC - 2A/30VDC			100mA/8VDC - 2A/30VDC		
<b>线圈参数 COIL DATA</b>						
额定电压 Rated Voltage	12VDC	24VDC	48VDC	12VDC	24VDC	48VDC
吸合电压 Pick-up Voltage	≤9VDC	≤18VDC	≤36VDC	≤9VDC	≤18VDC	≤36VDC
释放电压 Drop-out Voltage	≥1.2VDC	≥2.4VDC	≥4.8VDC	≥1.2VDC	≥2.4VDC	≥4.8VDC
线圈功率 Rated Operating Power	约 Approx 6W	约 Approx 6W	约 Approx 6W	约 Approx 6W	约 Approx 6W	约 Approx 6W
最大允许电压 Max. Allowable Voltage	16VDC	32VDC	64VDC	16VDC	32VDC	64VDC
<b>性能参数 CHARACTERISTICS DATA</b>						
介电耐压 Dielectric Strength	触点与线圈间 Between Contacts And Coil	4000VAC 1min		4000VAC 1min		
	断开触点间 Between Open Contacts	3000VAC 1min		3000VAC 1min		
绝缘电阻 Insulation Resistance	触点与线圈间 Between Contacts And Coil	1000MΩ(1000VDC)		1000MΩ(1000VDC)		
	断开触点间 Between Open Contacts	1000MΩ(1000VDC)		1000MΩ(1000VDC)		
耐冲击 Shock Resistance	功能性 Functional	20G 半正弦波 Half-Sine Wave 11ms		20G 半正弦波 Half-Sine Wave 11ms		
	强度 Destructive	50G 半正弦波 Half-Sine Wave 6ms		50G 半正弦波 Half-Sine Wave 6ms		
耐振动 Vibration Resistance	功能性 Functional	5.79G (10~ 2000Hz, 随机Random)		5.79G (10~ 2000Hz, 随机Random)		
	吸合时间 Operate Time	Max:30ms		Max:30ms		
	释放时间 Release Time	Max:10ms		Max:10ms		
	机械寿命 Mechanical Life	2*10 <sup>5</sup> 次(ops)		2*10 <sup>5</sup> 次(ops)		
	重量 Weight	约 Approx 350g		约 Approx 350g		
<b>安全认证 INSTALLATION CERTIFICATION</b>						
认证范围 Scope of Certification	UL/CE/CB/SEMKO/CQC/CCC			UL/CE/CB/SEMKO/CQC/CCC		

## 特性参数 CHARACTERISTIC PARAMETER

产品型号	HCF250	HCF250B
产品图片		

### 主触点参数 MAIN CONTACT DATA

最大工作电压 Max. Switching Voltage	1500VDC	1500VDC
额定电流 Rated Current	250A	250A
触点形式 Contact Arrangement	一组常开 SPST-NO	一组常开 SPST-NO
触点压降 Contact Voltage Drop	≤0.125V (at 250A)	≤0.125V (at 250A)
短时承载电流 Limiting Short-time Current	375A:10min; 500A:120s; 1000A:20s; 2500A:0.6s	375A:5min; 600A:30s; 900A:10s; 2000A:0.6s
电寿命 (阻性负载) Electrical Life(Resistive Load)	250A 450VDC 1000次(ops) 250A 800VDC 500次(ops) 250A 1000VDC 500次(ops), 仅分断 Only Breaking 50A 1500VDC 6000次(ops) 50A 1500VDC 11000次(ops), 仅接通 Only Making	250A 450VDC 500次(ops) 250A 800VDC 200次(ops) 150A 1000VDC 500次(ops), 仅分断 Only Breaking 15A 1500VDC 6000次(ops) 30A 1500VDC 11000次(ops), 仅接通 Only Making
最大分断电流(阻性负载) Max. Breaking Current(Resistive Load)	2000A 450VDC 1次(ops)	2000A 450VDC 1次(ops)
过载分断(阻性负载) Overload Breaking(Resistive Load)	500A 450VDC 10次(ops)	300A 450VDC 100次(ops)
耐短路电流 Short Circuit Current Withstanding	8000A(5ms)无冒烟, 无起火 No Smoke Or Fire	/

### 辅助触点参数 AUXILIARY CONTACT DATA

辅助触点 Auxiliary Contact	可选配 Optional	可选配 Optional
辅助触点形式 Auxiliary Contact Arrangement	一组常开 SPST-NO	一组常开 SPST-NO
辅助触点电流范围 Auxiliary Contact Current Range	100mA/8VDC ~ 2A/30VDC	100mA/8VDC ~ 2A/30VDC

### 线圈参数 COIL DATA

额定电压 Rated Voltage	12VDC	24VDC	48VDC	12VDC	24VDC	48VDC
吸合电压 Pick-up Voltage	≤9VDC	≤18VDC	≤36VDC	≤9VDC	≤18VDC	≤36VDC
释放电压 Drop-out Voltage	≥1.2VDC	≥2.4VDC	≥4.8VDC	≥1.2VDC	≥2.4VDC	≥4.8VDC
线圈功率 Rated Operating Power	约 Approx 6W	约 Approx 6W	约 Approx 6W	约 Approx 6W	约 Approx 6W	约 Approx 6W
最大允许电压 Max. Allowable Voltage	16VDC	32VDC	64VDC	16VDC	32VDC	64VDC

### 性能参数 CHARACTERISTICS DATA

介质耐压 Dielectric Strength	触点与线圈间 Between Contacts And Coil	4000VAC 1min	4000VAC 1min
	断开触点间 Between Open Contacts	3000VAC 1min	3000VAC 1min
绝缘电阻 Insulation Resistance	触点与线圈间 Between Contacts And Coil	1000MΩ(1000VDC)	1000MΩ(1000VDC)
	断开触点间 Between Open Contacts	1000MΩ(1000VDC)	1000MΩ(1000VDC)
耐冲击 Shock Resistance	功能性 Functional	20G 半正弦波 Half-Sine Wave 11ms	20G 半正弦波 Half-Sine Wave 11ms
	强度 Destructive	50G 半正弦波 Half-Sine Wave 6ms	50G 半正弦波 Half-Sine Wave 6ms
耐振动 Vibration Resistance	功能性 Functional	5.79G (10~2000Hz, 随机Random)	5.79G (10~2000Hz, 随机Random)
	吸合时间 Operate Time	Max:30ms	Max:30ms
释放时间 Release Time	Max:10ms	Max:10ms	
机械寿命 Mechanical Life	2*10 <sup>5</sup> 次(ops)	2*10 <sup>5</sup> 次(ops)	
重量 Weight	约 Approx 415g	约 Approx 350g	

### 安全认证 INSTALLATION CERTIFICATION

认证范围 Scope of Certification	UL/CE/CB/SEMKO/CQC/CCC	UL/CE/CB/SEMKO/CQC/CCC
--------------------------------	------------------------	------------------------

## 特性参数 CHARACTERISTIC PARAMETER

产品型号	HCF250C			HCF250D		
产品图片						
<b>主触点参数 MAIN CONTACT DATA</b>						
最大工作电压 Max. Switching Voltage	1500VDC			1500VDC		
额定电流 Rated Current	250A			250A		
触点形式 Contact Arrangement	一组常开 SPST-NO			一组常开 SPST-NO		
触点压降 Contact Voltage Drop	≤0.125V (at 250A)			≤0.125V(at 250A)		
短时承载电流 Limiting Short-time Current	600A:500s; 900A:80s; 1200A:20s; 3000A:0.6s			600A:500s; 900A:80s; 1200A:20s; 3000A:0.6s		
电寿命 (阻性负载) Electrical Life(Resistive Load)	250A 450VDC 2000 次(ops) 250A 800VDC 800 次(ops) 250A 1000VDC 800 次(ops),仅分断 Only Breaking 250A 1500VDC 200 次 (ops),仅分断 Only Breaking			250A 450VDC 2000 次(ops) 250A 800VDC 800 次(ops) 250A 1000VDC 1500 次(ops),仅分断 Only Breaking 250A 1500VDC 800 次 (ops),仅分断 Only Breaking		
最大分断电流(阻性负载) Max. Breaking Current(Resistive Load)	2500A 800VDC 1 次(ops)			2500A 800VDC 1 次(ops)		
过载分断(阻性负载) Overload Breaking(Resistive Load)	800A 450VDC 50 次(ops)			800A 450VDC 50 次(ops)		
耐短路电流 Short Circuit Current Withstanding	8000A(10ms) 不冒烟、不起火 No Smoke or Fire			8000A(10ms) 不冒烟、不起火 No Smoke or Fire		
<b>辅助触点参数 AUXILIARY CONTACT DATA</b>						
辅助触点 Auxiliary Contact	可选配 Optional			可选配 Optional		
辅助触点形式 Auxiliary Contact Arrangement	一组常开 SPST-NO			一组常开 SPST-NO		
辅助触点电流范围 Auxiliary Contact Current Range	100mA/8VDC - 2A/30VDC			100mA/8VDC - 2A/30VDC		
<b>线圈参数 COIL DATA</b>						
额定电压 Rated Voltage	12VDC	24VDC	48VDC	12VDC	24VDC	48VDC
吸合电压 Pick-up Voltage	≤9VDC	≤18VDC	≤36VDC	≤9VDC	≤18VDC	≤36VDC
释放电压 Drop-out Voltage	≥1.2VDC	≥2.4VDC	≥4.8VDC	≥1.2VDC	≥2.4VDC	≥4.8VDC
线圈功率 Rated Operating Power	约 Approx 55W(启动 Start); 5W(保持 Hold)	约 Approx 55W(启动 Start); 5W(保持 Hold)	约 Approx 55W(启动 Start); 5W(保持 Hold)	约 Approx 55W(启动 Start); 5W(保持 Hold)	约 Approx 55W(启动 Start); 5W(保持 Hold)	约 Approx 55W(启动 Start); 5W(保持 Hold)
最大允许电压 Max. Allowable Voltage	16VDC	32VDC	64VDC	16VDC	32VDC	64VDC
<b>性能参数 CHARACTERISTICS DATA</b>						
介质耐压 Dielectric Strength	触点与线圈间 Between Contacts And Coil	4000VAC 1min			4000VAC 1min	
	断开触点间 Between Open Contacts	3000VAC 1min			3000VAC 1min	
绝缘电阻 Insulation Resistance	触点与线圈间 Between Contacts And Coil	1000MΩ (1500VDC)			1000MΩ (1500VDC)	
	断开触点间 Between Open Contacts	1000MΩ (1500VDC)			1000MΩ (1500VDC)	
耐冲击 Shock Resistance	功能性 Functional	20G 半正弦波 Half-Sine Wave 11ms			20G 半正弦波 Half-Sine Wave 11ms	
	强度 Destructive	50G 半正弦波 Half-Sine Wave 6ms			50G 半正弦波 Half-Sine Wave 6ms	
耐振动 Vibration Resistance	功能性 Functional	5.79G (10~ 2000Hz, 随机Random)			5.79G (10~ 2000Hz, 随机Random)	
	吸合时间 Operate Time	Max:30ms			Max:30ms	
释放时间 Release Time	Max:10ms			Max:10ms		
机械寿命 Mechanical Life	2*10 <sup>5</sup> 次(ops)			2*10 <sup>5</sup> 次(ops)		
重量 Weight	约 Approx 700g			约 Approx 700g		
<b>安全认证 INSTALLATION CERTIFICATION</b>						
认证范围 Scope of Certification	UL/CE/CB/SEMKO/CQC/CCC			UL/CE/CB/SEMKO/CQC/CCC		

## 特性参数 CHARACTERISTIC PARAMETER

产品型号	HCF250E	HCF300
产品图片		

### 主触点参数 MAIN CONTACT DATA

最大工作电压 Max. Switching Voltage	1500VDC	1500VDC
额定电流 Rated Current	250A	300A
触点形式 Contact Arrangement	一组常开 SPST-NO	一组常开 SPST-NO
触点压降 Contact Voltage Drop	≤0.05V(at 250A)	≤0.15V (at 300A)
短时承载电流 Limiting Short-time Current	400A:2500s; 500A:900s; 800A:150s; 1000A:100s; 2000A:1.5s	450A:5min; 600A:120s; 1000A:25s; 2500A:0.6s
电寿命 (阻性负载) Electrical Life(Resistive Load)	100A 1500VDC 6000 次(ops) 150A 1500VDC 3000 次(ops), 仅分断 Only Breaking 250A 1500VDC 1000 次(ops), 仅分断 Only Breaking	300A 450VDC 800次(ops) 300A 800VDC 500次(ops) 300A 1000VDC 200次(ops) , 仅分断 Only Breaking 50A 1500VDC 6000次(ops) 50A 1500VDC 11000次(ops) , 仅接通 Only Making
最大分断电流(阻性负载) Max. Breaking Current(Resistive Load)	2000A 1000VDC 1 次(ops)	2000A 450VDC 1次(ops)
过载分断(阻性负载) Overload Breaking(Resistive Load)	1000A 900VDC 100 次(ops)	600A 450VDC 10次(ops)
耐短路电流 Short Circuit Current Withstanding	8000A(5ms)无冒烟, 无起火 No Smoke Or Fire	8000A(5ms)无冒烟, 无起火 No Smoke Or Fire

### 辅助触点参数 AUXILIARY CONTACT DATA

辅助触点 Auxiliary Contact	可选配 Optional	可选配 Optional
辅助触点形式 Auxiliary Contact Arrangement	一组常开 SPST-NO	一组常开 SPST-NO
辅助触点电流范围 Auxiliary Contact Current Range	100mA/8VDC ~ 2A/30VDC	100mA/8VDC ~ 2A/30VDC

### 线圈参数 COIL DATA

额定电压 Rated Voltage	12VDC	24VDC	48VDC	12VDC	24VDC	48VDC
吸合电压 Pick-up Voltage	≤9VDC	≤18VDC	≤36VDC	≤9VDC	≤18VDC	≤36VDC
释放电压 Drop-out Voltage	≥1.2VDC	≥2.4VDC	≥4.8VDC	≥1.2VDC	≥2.4VDC	≥4.8VDC
线圈功率 Rated Operating Power	约 Approx 60W启动 Start; 5.4W保持 Hold	约 Approx 60W启动 Start; 5.4W保持 Hold	约 Approx 60W启动 Start; 5.4W保持 Hold	约 Approx 6W	约 Approx 6W	约 Approx 6W
最大允许电压 Max. Allowable Voltage	16VDC	32VDC	64VDC	16VDC	32VDC	64VDC

### 性能参数 CHARACTERISTICS DATA

介质耐压 Dielectric Strength	触点与线圈间 Between Contacts And Coil	4000VAC 1min	4000VAC 1min
	断开触点间 Between Open Contacts	3000VAC 1min	3000VAC 1min
绝缘电阻 Insulation Resistance	触点与线圈间 Between Contacts And Coil	1000MΩ (1500VDC)	1000MΩ(1000VDC)
	断开触点间 Between Open Contacts	1000MΩ (1500VDC)	1000MΩ(1000VDC)
耐冲击 Shock Resistance	功能性 Functional	20G 半正弦波 Half-Sine Wave 11ms	20G 半正弦波 Half-Sine Wave 11ms
	强度 Destructive	50G 半正弦波 Half-Sine Wave 6ms	50G 半正弦波 Half-Sine Wave 6ms
耐振动 Vibration Resistance	功能性 Functional	5.79G (10~ 2000Hz, 随机Random)	5.79G (10~ 2000Hz, 随机Random)
	吸合时间 Operate Time	Max:30ms	Max:30ms
释放时间 Release Time	Max:10ms	Max:10ms	
机械寿命 Mechanical Life	2*10 <sup>8</sup> 次(ops)	2*10 <sup>8</sup> 次(ops)	
重量 Weight	约 Approx1300g	约 Approx 415g	

### 安全认证 INSTALLATION CERTIFICATION

认证范围 Scope of Certification	UL/CE/CB/SEMKO/CQC/CCC	UL/CE/CB/SEMKO/CQC/CCC
--------------------------------	------------------------	------------------------

## 特性参数 CHARACTERISTIC PARAMETER

产品型号	HCF350	HCF400
产品图片		

## 主触点参数 MAIN CONTACT DATA

最大工作电压 Max. Switching Voltage	2000VDC	1500VDC
额定电流 Rated Current	350A	400A
触点形式 Contact Arrangement	一组常开 SPST-NO	一组常开 SPST-NO
触点压降 Contact Voltage Drop	≤0.07V(at 350A)	≤0.2V (at 400A)
短时承载电流 Limiting Short-time Current	400A:10min; 600A:90s; 1000A:30s; 2000A:1s	600A:15min; 900A:120s; 1200A:30s; 3000A:0.6s
电寿命 (阻性负载) Electrical Life(Resistive Load)	100A 1500VDC, 6000 次(ops),仅分断 Only Breaking 150A 1500VDC, 3000 次(ops),仅分断 Only Breaking 350A 1500VDC, 1000 次(ops),仅分断 Only Breaking 350A 2000VDC, 500 次(ops),仅分断 Only Breaking	400A 450VDC 2000 次(ops) 400A 800VDC 800 次(ops) 400A 1000VDC 300 次(ops),仅分断 Only Breaking 250A 1500VDC 300 次(ops),仅分断 Only Breaking 400A 1500VDC 100 次(ops),仅分断 Only Breaking
最大分断电流(阻性负载) Max. Breaking Current(Resistive Load)	2000A 320VDC 1次(ops)	2500A 800VDC 1次(ops)
过载分断(阻性负载) Overload Breaking(Resistive Load)	1000A 900VDC 50次(ops)	800A 450VDC 50次(ops)
耐短路电流 Short Circuit Current Withstanding	8000A(5ms)无冒烟, 无起火 No Smoke Or Fire	8000A(10ms)无冒烟, 无起火 No Smoke Or Fire

## 辅助触点参数 AUXILIARY CONTACT DATA

辅助触点 Auxiliary Contact	可选配 Optional	可选配 Optional
辅助触点形式 Auxiliary Contact Arrangement	一组常开 SPST-NO	一组常开 SPST-NO
辅助触点电流范围 Auxiliary Contact Current Range	100mA/8VDC ~ 2A/30VDC	100mA/8VDC ~ 2A/30VDC

## 线圈参数 COIL DATA

额定电压 Rated Voltage	12VDC	24VDC	48VDC	12VDC	24VDC	48VDC
吸合电压 Pick-up Voltage	≤9VDC	≤18VDC	≤36VDC	≤9VDC	≤18VDC	≤36VDC
释放电压 Drop-out Voltage	≥1.2VDC	≥2.4VDC	≥4.8VDC	≥1.2VDC	≥2.4VDC	≥4.8VDC
线圈功率 Rated Operating Power	约 Approx 65W(启动 Start); 5.4W(保持 Hold)	约 Approx 65W(启动 Start); 5.4W(保持 Hold)	约 Approx 65W(启动 Start); 5.4W(保持 Hold)	约 Approx 55W(启动 Start); 5W(保持 Hold)	约 Approx 55W(启动 Start); 5W(保持 Hold)	约 Approx 55W(启动 Start); 5W(保持 Hold)
最大允许电压 Max. Allowable Voltage	16VDC	32VDC	64VDC	16VDC	32VDC	64VDC

## 性能参数 CHARACTERISTICS DATA

介质耐压 Dielectric Strength	触点与线圈间 Between Contacts And Coil	5000VAC 1min	4000VAC 1min
	断开触点间 Between Open Contacts	5000VAC 1min	3000VAC 1min
绝缘电阻 Insulation Resistance	触点与线圈间 Between Contacts And Coil	1000MΩ (2000VDC)	1000MΩ (1500VDC)
	断开触点间 Between Open Contacts	1000MΩ (2000VDC)	1000MΩ (1500VDC)
耐冲击 Shock Resistance	功能性 Functional	20G 半正弦波 Half-Sine Wave 11ms	20G 半正弦波 Half-Sine Wave 11ms
	强度 Destructive	50G 半正弦波 Half-Sine Wave 6ms	50G 半正弦波 Half-Sine Wave 6ms
耐振动 Vibration Resistance	功能性 Functional	5.79G (10~ 2000Hz, 随机Random)	5.79G (10~ 2000Hz, 随机Random)
	吸合时间 Operate Time	Max:50ms	Max:30ms
释放时间 Release Time	Max:30ms	Max:10ms	
机械寿命 Mechanical Life	2*10 <sup>7</sup> 次(ops)	2*10 <sup>7</sup> 次(ops)	
重量 Weight	约 Approx 1300g	约 Approx 700g	

## 安全认证 INSTALLATION CERTIFICATION

认证范围 Scope of Certification	UL/CE/CB/SEMKO/CQC/CCC	UL/CE/CB/SEMKO/CQC/CCC
--------------------------------	------------------------	------------------------

特性参数 CHARACTERISTIC PARAMETER

产品型号	HCF400B	HCF400C
产品图片		

主触点参数 MAIN CONTACT DATA

最大工作电压 Max. Switching Voltage	1500VDC	1500VDC
额定电流 Rated Current	400A	400A
触点形式 Contact Arrangement	一组常开 SPST-NO	一组常开 SPST-NO
触点压降 Contact Voltage Drop	≤0.2V (at 400A)	≤0.2V (at 400A)
短时承载电流 Limiting Short-time Current	600A:15min; 900A:120s; 1200A:30s; 3000A:0.6s	400A:持续 Cont; 600A:5min; 800A:2min; 1200A:25s; 2500A:1s
电寿命 (阻性负载) Electrical Life(Resistive Load)	400A 450VDC 2000次 ( ops) 400A 800VDC 800次 ( ops) 400A 1000VDC 200次(ops), 仅分断Only Breaking 400A 1500VDC 30次(ops), 仅分断Only Breaking	400A 450VDC 400次(ops), 仅分断 Only Breaking 400A 800VDC 100次(ops), 仅分断 Only Breaking 300A 1000VDC 200次(ops), 仅分断 Only Breaking 50A 1500VDC 6000次(ops); 50A 1500VDC 11000次(ops)仅接通 Only Making;
最大分断电流(阻性负载) Max. Breaking Current(Resistive Load)	2500A 800VDC 1次(ops)	2000A 450VDC 1次(ops)
过载分断(阻性负载) Overload Breaking(Resistive Load)	800A 450VDC 50次(ops)	600A 450VDC 10次(ops)
耐短路电流 Short Circuit Current Withstanding	8000A(10ms)无冒烟, 无起火 No Smoke Or Fire	8000A(5ms)无冒烟, 无起火 No Smoke Or Fire

辅助触点参数 AUXILIARY CONTACT DATA

辅助触点 Auxiliary Contact	可选配 Optional	可选配 Optional
辅助触点形式 Auxiliary Contact Arrangement	一组常开 SPST-NO	一组常开 SPST-NO
辅助触点电流范围 Auxiliary Contact Current Range	100mA/8VDC ~ 2A/30VDC	100mA/8VDC ~ 2A/30VDC

线圈参数 COIL DATA

额定电压 Rated Voltage	12VDC	24VDC	48VDC	12VDC	24VDC	48VDC
吸合电压 Pick-up Voltage	≤9VDC	≤18VDC	≤36VDC	≤9VDC	≤18VDC	≤36VDC
释放电压 Drop-out Voltage	≥1.2VDC	≥2.4VDC	≥4.8VDC	≥1.2VDC	≥2.4VDC	≥4.8VDC
线圈功率 Rated Operating Power	约 Approx 55W(启动 Start); 5W(保持 Hold)	约 Approx 55W(启动 Start); 5W(保持 Hold)	约 Approx 55W(启动 Start); 5W(保持 Hold)	约 Approx 6W	约 Approx 6W	约 Approx 6W
最大允许电压 Max. Allowable Voltage	16VDC	32VDC	64VDC	16VDC	32VDC	64VDC

性能参数 CHARACTERISTICS DATA

介质耐压 Dielectric Strength	触点与线圈间 Between Contacts And Coil	4000VAC 1min	4000VAC 1min
	断开触点间 Between Open Contacts	3000VAC 1min	3000VAC 1min
绝缘电阻 Insulation Resistance	触点与线圈间 Between Contacts And Coil	1000MΩ (1500VDC)	1000MΩ(1000VDC)
	断开触点间 Between Open Contacts	1000MΩ (1500VDC)	1000MΩ(1000VDC)
耐冲击 Shock Resistance	功能性 Functional	20G 半正弦波 Half-Sine Wave 11ms	20G 半正弦波 Half-Sine Wave 11ms
	强度 Destructive	50G 半正弦波 Half-Sine Wave 6ms	50G 半正弦波 Half-Sine Wave 6ms
耐振动 Vibration Resistance	功能性 Functional	5.79G (10~ 2000Hz, 随机Random)	5.79G (10~ 2000Hz, 随机Random)
	吸合时间 Operate Time	Max:30ms	Max:30ms
释放时间 Release Time	Max:10ms	Max:10ms	
机械寿命 Mechanical Life	2*10 <sup>7</sup> 次(ops)	2*10 <sup>7</sup> 次(ops)	
重量 Weight	约 Approx 700g	约 Approx 415g	

安全认证 INSTALLATION CERTIFICATION

认证范围 Scope of Certification	UL/CE/CB/SEMKO/CQC/CCC	UL/CE/CB/SEMKO/CQC/CCC
--------------------------------	------------------------	------------------------



## 特性参数 CHARACTERISTIC PARAMETER

产品型号	HCF500	HCF500B
产品图片		

### 主触点参数 MAIN CONTACT DATA

最大工作电压 Max. Switching Voltage	1500VDC	1500VDC
额定电流 Rated Current	500A	500A
触点形式 Contact Arrangement	一组常开 SPST-NO	一组常开 SPST-NO
触点压降 Contact Voltage Drop	≤0.1V (at 500A)	≤0.1V (at 500A)
短时承载电流 Limiting Short-time Current	700A:8min; 1000A:50s; 2000A:5s; 3000A:1s	700A:8min; 1000A:50s; 2000A:5s; 3000A:1s
电寿命 (阻性负载) Electrical Life(Resistive Load)	500A 450VDC 2000次 (ops), 仅分断 Only Breaking 500A 800VDC 800次 (ops), 仅分断 Only Breaking 500A 1000VDC 500次 (ops), 仅分断 Only Breaking 400A 1500VDC 150次 (ops), 仅分断 Only Breaking	500A 450VDC 2000次 (ops), 仅分断 Only Breaking 500A 800VDC 800次 (ops), 仅分断 Only Breaking 500A 1000VDC 200次 (ops), 仅分断 Only Breaking 400A 1500VDC 30次 (ops), 仅分断 Only Breaking
最大分断电流(阻性负载) Max. Breaking Current(Resistive Load)	2500A 800VDC 1次(ops)	2500A 800VDC 1次(ops)
过载分断(阻性负载) Overload Breaking(Resistive Load)	800A 450VDC 50次(ops)	800A 450VDC 50次(ops)
耐短路电流 Short Circuit Current Withstanding	8000A(10ms)无冒烟, 无起火 No Smoke Or Fire	8000A(10ms)无冒烟, 无起火 No Smoke Or Fire

### 辅助触点参数 AUXILIARY CONTACT DATA

辅助触点 Auxiliary Contact	可选配 Optional	可选配 Optional
辅助触点形式 Auxiliary Contact Arrangement	一组常开 SPST-NO	一组常开 SPST-NO
辅助触点电流范围 Auxiliary Contact Current Range	100mA/8VDC ~ 2A/30VDC	100mA/8VDC ~ 2A/30VDC

### 线圈参数 COIL DATA

	12VDC	24VDC	48VDC	12VDC	24VDC	48VDC
额定电压 Rated Voltage	12VDC	24VDC	48VDC	12VDC	24VDC	48VDC
吸合电压 Pick-up Voltage	≤9VDC	≤18VDC	≤36VDC	≤9VDC	≤18VDC	≤36VDC
释放电压 Drop-out Voltage	≥1.2VDC	≥2.4VDC	≥4.8VDC	≥1.2VDC	≥2.4VDC	≥4.8VDC
线圈功率 Rated Operating Power	约 Approx 55W(启动 Start); 5W(保持 Hold)	约 Approx 55W(启动 Start); 5W(保持 Hold)	约 Approx 55W(启动 Start); 5W(保持 Hold)	约 Approx 55W(启动 Start); 5W(保持 Hold)	约 Approx 55W(启动 Start); 5W(保持 Hold)	约 Approx 55W(启动 Start); 5W(保持 Hold)
最大允许电压 Max. Allowable Voltage	16VDC	32VDC	64VDC	16VDC	32VDC	64VDC

### 性能参数 CHARACTERISTICS DATA

介质耐压 Dielectric Strength	触点与线圈间 Between Contacts And Coil	4000VAC 1min	4000VAC 1min
	断开触点间 Between Open Contacts	3000VAC 1min	3000VAC 1min
绝缘电阻 Insulation Resistance	触点与线圈间 Between Contacts And Coil	1000MΩ (1500VDC)	1000MΩ (1500VDC)
	断开触点间 Between Open Contacts	1000MΩ (1500VDC)	1000MΩ (1500VDC)
耐冲击 Shock Resistance	功能性 Functional	20G 半正弦波 Half-Sine Wave 11ms	20G 半正弦波 Half-Sine Wave 11ms
	强度 Destructive	50G 半正弦波 Half-Sine Wave 6ms	50G 半正弦波 Half-Sine Wave 6ms
耐振动 Vibration Resistance	功能性 Functional	5.79G (10~ 2000Hz, 随机Random)	5.79G (10~ 2000Hz, 随机Random)
	吸合时间 Operate Time	Max:30ms	Max:30ms
释放时间 Release Time	Max:10ms	Max:10ms	
机械寿命 Mechanical Life	2*10 <sup>5</sup> 次(ops)	2*10 <sup>5</sup> 次(ops)	
重量 Weight	约 Approx 700g	约 Approx 700g	

### 安全认证 INSTALLATION CERTIFICATION

认证范围 Scope of Certification	UL/CE/CB/SEMKO/CQC/CCC	UL/CE/CB/SEMKO/CQC/CCC
--------------------------------	------------------------	------------------------

## 特性参数 CHARACTERISTIC PARAMETER

产品型号	HCF600	HCF700
产品图片		

### 主触点参数 MAIN CONTACT DATA

最大工作电压 Max. Switching Voltage	2000VDC	1500VDC
额定电流 Rated Current	600A	700A
触点形式 Contact Arrangement	一组常开 SPST-NO	一组常开 SPST-NO
触点压降 Contact Voltage Drop	≤0.12V (at 600A)	≤0.12V (at 700A)
短时承载电流 Limiting Short-time Current	700A:10min; 1000A:60s; 1600A:10s; 3000A:1s	1000A:60S;1600A:10S;3000A:1S
电寿命 (阻性负载) Electrical Life(Resistive Load)	600A 450VDC 2000 次 (ops) 600A 800VDC 1500 次 (ops) 600A 1000VDC 1000 次 (ops) 600A 1500VDC 150 次(ops),仅分断 Only Breaking 600A 2000VDC 100 次(ops),仅分断 Only Breaking	700A 450VDC 1000次 (ops),仅分断 Only Breaking 700A 1000VDC 500次 (ops),仅分断 Only Breaking 600A 1500VDC 200次 (ops),仅分断 Only Breaking 350A 1500VDC 1000次 (ops),仅分断 Only Breaking
最大分断电流(阻性负载) Max. Breaking Current(Resistive Load)	2500A 800VDC 1次(ops)	2500A 800VDC 1次(ops)
过载分断(阻性负载) Overload Breaking(Resistive Load)	1000A 900VDC 50次 (ops)	1000A 900VDC 50次(ops)
耐短路电流 Short Circuit Current Withstanding	8000A(10ms)无冒烟, 无起火 No Smoke Or Fire	8000A(10ms)无冒烟, 无起火 No Smoke Or Fire

### 辅助触点参数 AUXILIARY CONTACT DATA

辅助触点 Auxiliary Contact	可选配 Optional	可选配 Optional
辅助触点形式 Auxiliary Contact Arrangement	一组常开 SPST-NO	一组常开 SPST-NO
辅助触点电流范围 Auxiliary Contact Current Range	100mA/8VDC ~ 2A/30VDC	100mA/8VDC ~ 2A/30VDC

### 线圈参数 COIL DATA

	12VDC	24VDC	48VDC	12VDC	24VDC	48VDC
额定电压 Rated Voltage	12VDC	24VDC	48VDC	12VDC	24VDC	48VDC
吸合电压 Pick-up Voltage	≤9VDC	≤18VDC	≤36VDC	≤9VDC	≤18VDC	≤36VDC
释放电压 Drop-out Voltage	≥1.2VDC	≥2.4VDC	≥4.8VDC	≥1.2VDC	≥2.4VDC	≥4.8VDC
线圈功率 Rated Operating Power	约 Approx 65W启动 Start; 5.4W保持 Hold	约 Approx 65W启动 Start; 5.4W保持 Hold	约 Approx 65W启动 Start; 5.4W保持 Hold	约 Approx 65W启动 Start; 5.4W保持 Hold	约 Approx 65W启动 Start; 5.4W保持 Hold	约 Approx 65W启动 Start; 5.4W保持 Hold
最大允许电压 Max. Allowable Voltage	16VDC	32VDC	64VDC	16VDC	32VDC	64VDC

### 性能参数 CHARACTERISTICS DATA

介质耐压 Dielectric Strength	触点与线圈间 Between Contacts And Coil	4000VAC 1min	4000VAC 1min
	断开触点间 Between Open Contacts	3000VAC 1min	3000VAC 1min
绝缘电阻 Insulation Resistance	触点与线圈间 Between Contacts And Coil	1000MΩ (1500VDC)	1000MΩ (1500VDC)
	断开触点间 Between Open Contacts	1000MΩ (1500VDC)	1000MΩ (1500VDC)
耐冲击 Shock Resistance	功能性 Functional	20G 半正弦波 Half-Sine Wave 11ms	20G 半正弦波 Half-Sine Wave 11ms
	强度 Destructive	50G 半正弦波 Half-Sine Wave 6ms	50G 半正弦波 Half-Sine Wave 6ms
耐振动 Vibration Resistance	功能性 Functional	5.79G (10~ 2000Hz, 随机Random)	5.79G (10~ 2000Hz, 随机Random)
	吸合时间 Operate Time	Max:50ms	Max:50ms
释放时间 Release Time	Max:30ms	Max:30ms	
机械寿命 Mechanical Life	2*10 <sup>5</sup> 次(ops)	2*10 <sup>5</sup> 次(ops)	
重量 Weight	约 Approx 1300g	约 Approx 1300g	

### 安全认证 INSTALLATION CERTIFICATION

认证范围 Scope of Certification	UL/CE/CB/SEMKO/CQC/CCC	UL/CE/CB/SEMKO/CQC/CCC
--------------------------------	------------------------	------------------------

## 特性参数 CHARACTERISTIC PARAMETER

产品型号	HCF800A	HCF800B
产品图片	 	 

### 主触点参数 MAIN CONTACT DATA

最大工作电压 Max. Switching Voltage	2000VDC	2000VDC
额定电流 Rated Current	800A	800A
触点形式 Contact Arrangement	一组常开 SPST-NO	一组常开 SPST-NO
触点压降 Contact Voltage Drop	≤0.2V(at 800A)	≤0.2V(at 800A)
短时承载电流 Limiting Short-time Current	800A:持续;1200A:130s;1600A:100s;2500A:25s;3500A:15s	800A:持续;1200A:130s;1600A:100s;2500A:25s;3500A:15s
电寿命 (阻性负载) Electrical Life(Resistive Load)	800A 1000VDC 100次 (ops) 800A 1500VDC 50次 (ops), 仅分断 Only Breaking	800A 1000VDC 100次 (ops) 800A 1500VDC 50次 (ops), 仅分断 Only Breaking
最大分断电流(阻性负载) Max. Breaking Current(Resistive Load)	2000A 1000VDC 1次(ops)	2000A 1000VDC 1次(ops)
过载分断(阻性负载) Overload Breaking(Resistive Load)	/	/
耐短路电流 Short Circuit Current Withstanding	10000A (2ms) 不冒烟、不起火 No Smoke or Fire	10000A (2ms) 不冒烟、不起火 No Smoke or Fire

### 辅助触点参数 AUXILIARY CONTACT DATA

辅助触点 Auxiliary Contact	可选配 Optional	可选配 Optional
辅助触点形式 Auxiliary Contact Arrangement	无 Nil: 无辅助触点 No Auxiliary Contact; H: 一组常开 SPST-NO; C: 一组常闭 SPST-NC; Z: 一组常开&一组常闭 SPST-NO&SPST-NC	无 Nil: 无辅助触点 No Auxiliary Contact; H: 一组常开 SPST-NO; C: 一组常闭 SPST-NC; Z: 一组常开&一组常闭 SPST-NO&SPST-NC
辅助触点电流范围 Auxiliary Contact Current Range	100mA/8VDC ~ 2A/30VDC	100mA/8VDC ~ 2A/30VDC

### 线圈参数 COIL DATA

额定电压 Rated Voltage	12VDC	24VDC	48VDC	12VDC	24VDC	48VDC
吸合电压 Pick-up Voltage	≤9VDC	≤18VDC	≤36VDC	≤9VDC	≤18VDC	≤36VDC
释放电压 Drop-out Voltage	≥1.2VDC	≥2.4VDC	≥4.8VDC	≥1.2VDC	≥2.4VDC	≥4.8VDC
线圈功率 Rated Operating Power	约 Approx 50W(启动 Start); 10W(保持 Hold)	约 Approx 50W(启动 Start); 10W(保持 Hold)	约 Approx 50W(启动 Start); 10W(保持 Hold)	约 Approx 50W(启动 Start); 10W(保持 Hold)	约 Approx 50W(启动 Start); 10W(保持 Hold)	约 Approx 50W(启动 Start); 10W(保持 Hold)
最大允许电压 Max. Allowable Voltage	16VDC	32VDC	64VDC	16VDC	32VDC	64VDC



### 性能参数 CHARACTERISTICS DATA

介质耐压 Dielectric Strength	触点与线圈间 Between Contacts And Coil	5000VAC 1min	5000VAC 1min
	断开触点间 Between Open Contacts	5000VAC 1min	5000VAC 1min
绝缘电阻 Insulation Resistance	触点与线圈间 Between Contacts And Coil	1000MΩ (1500VDC)	1000MΩ (1500VDC)
	断开触点间 Between Open Contacts	1000MΩ (1500VDC)	1000MΩ (1500VDC)
耐冲击 Shock Resistance	功能性 Functional	20G 半正弦波 Half-Sine Wave 11ms	20G 半正弦波 Half-Sine Wave 11ms
	强度 Destructive	50G 半正弦波 Half-Sine Wave 6ms	50G 半正弦波 Half-Sine Wave 6ms
耐振动 Vibration Resistance	功能性 Functional	5.79G (10~ 2000Hz, 随机Random)	5.79G (10~ 2000Hz, 随机Random)
	吸合时间 Operate Time	Max:100ms	Max:100ms
释放时间 Release Time	Max:30ms	Max:30ms	
机械寿命 Mechanical Life	2*10 <sup>5</sup> 次(ops)	2*10 <sup>5</sup> 次(ops)	
重量 Weight	约 Approx 3230g	约 Approx 3230g	

### 安全认证 INSTALLATION CERTIFICATION

认证范围 Scope of Certification	UL/CE/CB/SEMKO/CQC/CCC	UL/CE/CB/SEMKO/CQC/CCC
--------------------------------	------------------------	------------------------

## 特性参数 CHARACTERISTIC PARAMETER

产品型号	HCF1000A	HCF1000B
产品图片		

### 主触点参数 MAIN CONTACT DATA

最大工作电压 Max. Switching Voltage	1500VDC	1500VDC
额定电流 Rated Current	1000A	1000A
触点形式 Contact Arrangement	一组常开 SPST-NO	一组常开 SPST-NO
触点压降 Contact Voltage Drop	≤0.2V(at 1000A)	≤0.2V(at 1000A)
短时承载电流 Limiting Short-time Current	1000A:持续;1500A:140s;2000A:82s;3000A:30s;4000A:18s	1000A:持续;1500A:140s;2000A:82s;3000A:30s;4000A:18s
电寿命 (阻性负载) Electrical Life(Resistive Load)	60A 1000VDC 2000 次 (ops), 仅接通 Only Marking 1000A 1000VDC 100 次 (ops) 1000A 1500VDC 50 次 (ops), 仅分断 Only Breaking	60A 1000VDC 2000 次 (ops), 仅接通 Only Marking 1000A 1000VDC 100 次 (ops) 1000A 1500VDC 50 次 (ops), 仅分断 Only Breaking
最大分断电流(阻性负载) Max. Breaking Current(Resistive Load)	2000A 1000VDC 1次(ops)	2000A 1000VDC 1次(ops)
过载分断(阻性负载) Overload Breaking(Resistive Load)	/	/
耐短路电流 Short Circuit Current Withstanding	10000A (2ms) 不冒烟、不起火 No Smoke or Fire	10000A (2ms) 不冒烟、不起火 No Smoke or Fire

### 辅助触点参数 AUXILIARY CONTACT DATA

辅助触点 Auxiliary Contact	可选配 Optional	可选配 Optional
辅助触点形式 Auxiliary Contact Arrangement	无 Nil: 无辅助触点 No Auxiliary Contact; H: 一组常开 SPST-NO; C: 一组常闭 SPST-NC; Z: 一组常开&一组常闭 SPST-NO&SPST-NC	无 Nil: 无辅助触点 No Auxiliary Contact; H: 一组常开 SPST-NO; C: 一组常闭 SPST-NC; Z: 一组常开&一组常闭 SPST-NO&SPST-NC
辅助触点电流范围 Auxiliary Contact Current Range	100mA/8VDC ~ 2A/30VDC	100mA/8VDC ~ 2A/30VDC

### 线圈参数 COIL DATA

额定电压 Rated Voltage	12VDC	24VDC	48VDC	12VDC	24VDC	48VDC
吸合电压 Pick-up Voltage	≤9VDC	≤18VDC	≤36VDC	≤9VDC	≤18VDC	≤36VDC
释放电压 Drop-out Voltage	≥1.2VDC	≥2.4VDC	≥4.8VDC	≥1.2VDC	≥2.4VDC	≥4.8VDC
线圈功率 Rated Operating Power	约 Approx 50W(启动 Start); 10W(保持 Hold)	约 Approx 50W(启动 Start); 10W(保持 Hold)	约 Approx 50W(启动 Start); 10W(保持 Hold)	约 Approx 50W(启动 Start); 10W(保持 Hold)	约 Approx 50W(启动 Start); 10W(保持 Hold)	约 Approx 50W(启动 Start); 10W(保持 Hold)
最大允许电压 Max. Allowable Voltage	16VDC	32VDC	64VDC	16VDC	32VDC	64VDC

### 性能参数 CHARACTERISTICS DATA

介质耐压 Dielectric Strength	触点与线圈间 Between Contacts And Coil	5000VAC 1min	5000VAC 1min
	断开触点间 Between Open Contacts	5000VAC 1min	5000VAC 1min
绝缘电阻 Insulation Resistance	触点与线圈间 Between Contacts And Coil	1000MΩ (1500VDC)	1000MΩ (1500VDC)
	断开触点间 Between Open Contacts	1000MΩ (1500VDC)	1000MΩ (1500VDC)
耐冲击 Shock Resistance	功能性 Functional	20G 半正弦波 Half-Sine Wave 11ms	20G 半正弦波 Half-Sine Wave 11ms
	强度 Destructive	50G 半正弦波 Half-Sine Wave 6ms	50G 半正弦波 Half-Sine Wave 6ms
耐振动 Vibration Resistance	功能性 Functional	5.79G (10~2000Hz, 随机Random)	5.79G (10~2000Hz, 随机Random)
	吸合时间 Operate Time	Max:100ms	Max:100ms
释放时间 Release Time	Max:30ms	Max:30ms	
机械寿命 Mechanical Life	2*10 <sup>5</sup> 次(ops)	2*10 <sup>5</sup> 次(ops)	
重量 Weight	约 Approx 3230g	约 Approx 3230g	

### 安全认证 INSTALLATION CERTIFICATION

认证范围 Scope of Certification	UL/CE/CB/SEMKO/CQC/CCC	UL/CE/CB/SEMKO/CQC/CCC
--------------------------------	------------------------	------------------------

## 外形尺寸图 OUTLINE DIMENSIONS

### HCF20/□-□-HQ3

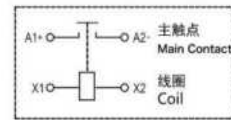
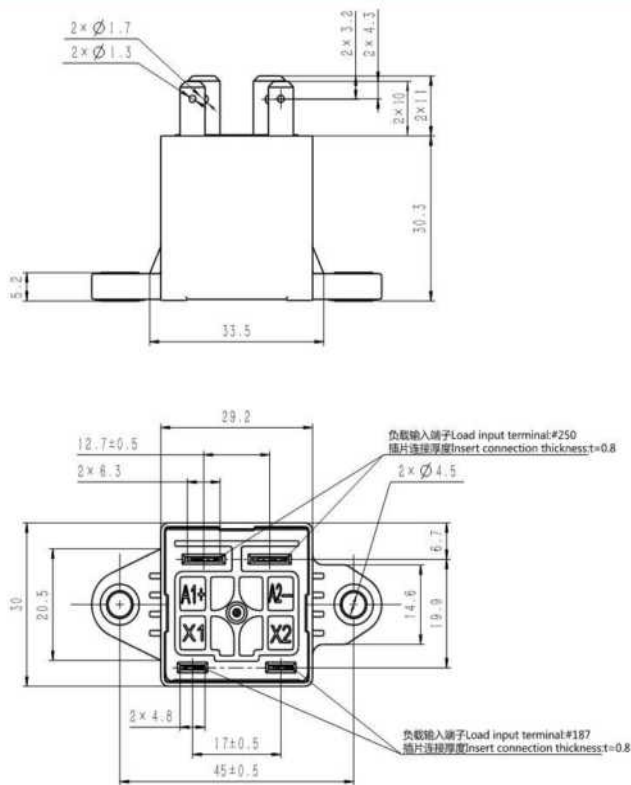

接线图  
Coil Wiring Diagram

未注公差 General Tolerance:  
 < 1.0mm: ± 0.3mm  
 1.0~5.0mm: ± 0.5mm  
 > 5.0mm: ± 0.8mm

### HCF20/□-□-HP4

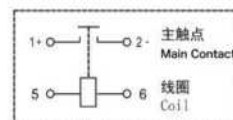
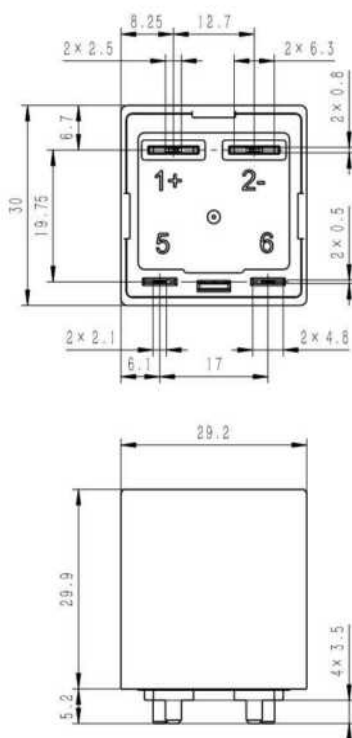

接线图  
Coil Wiring Diagram

未注公差 General Tolerance:  
 < 1.0mm: ± 0.3mm  
 1.0~5.0mm: ± 0.5mm  
 > 5.0mm: ± 0.8mm



## 外形尺寸图 OUTLINE DIMENSIONS

### HCF40B/□-□-HQ3

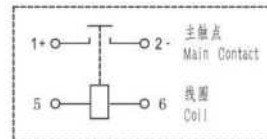
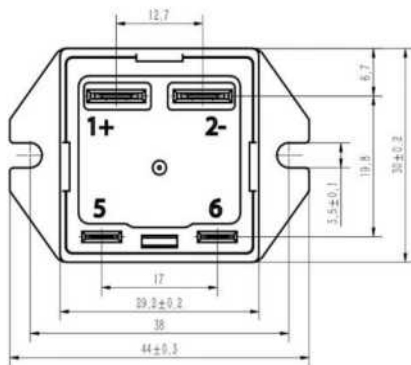
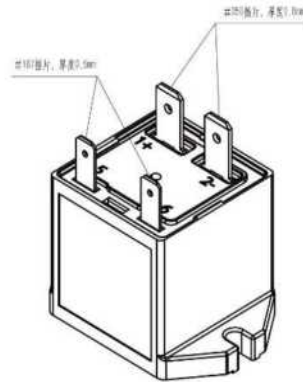
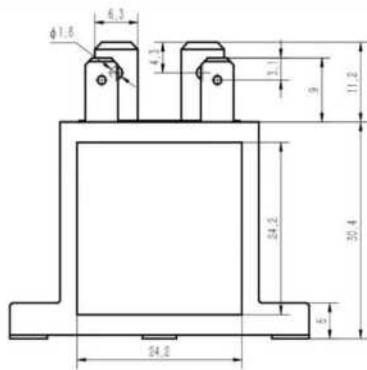

接线图  
Coil Wiring Diagram

未注公差 General Tolerance:  
 < 1.0mm: ±0.3mm  
 1.0~5.0mm: ±0.5mm  
 > 5.0mm: ±0.8mm

### HCF100/□-□-HC1

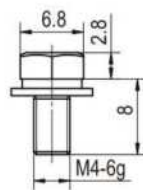
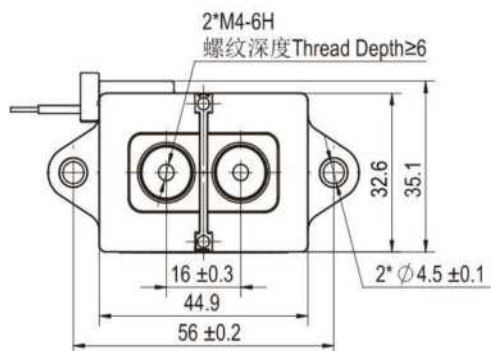
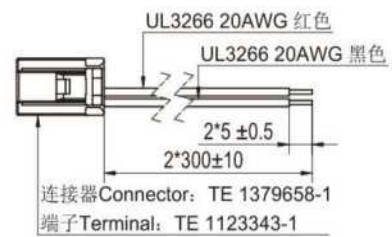
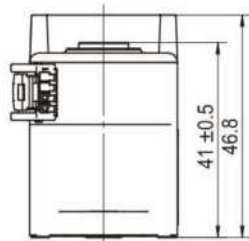
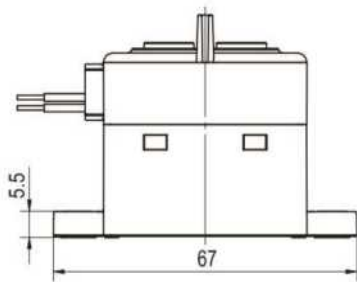

组合螺钉示意 (选配)  
Combination Screw(Optional)

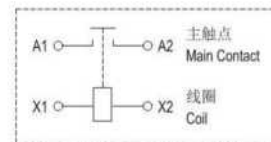

接线图  
Coil Wiring Diagram

未注公差 General Tolerance:  
 < 10mm: ±0.3mm  
 10~50mm: ±0.5mm  
 > 50mm: ±0.8mm

## 外形尺寸图 OUTLINE DIMENSIONS

### HCF100B/□-□-HC1

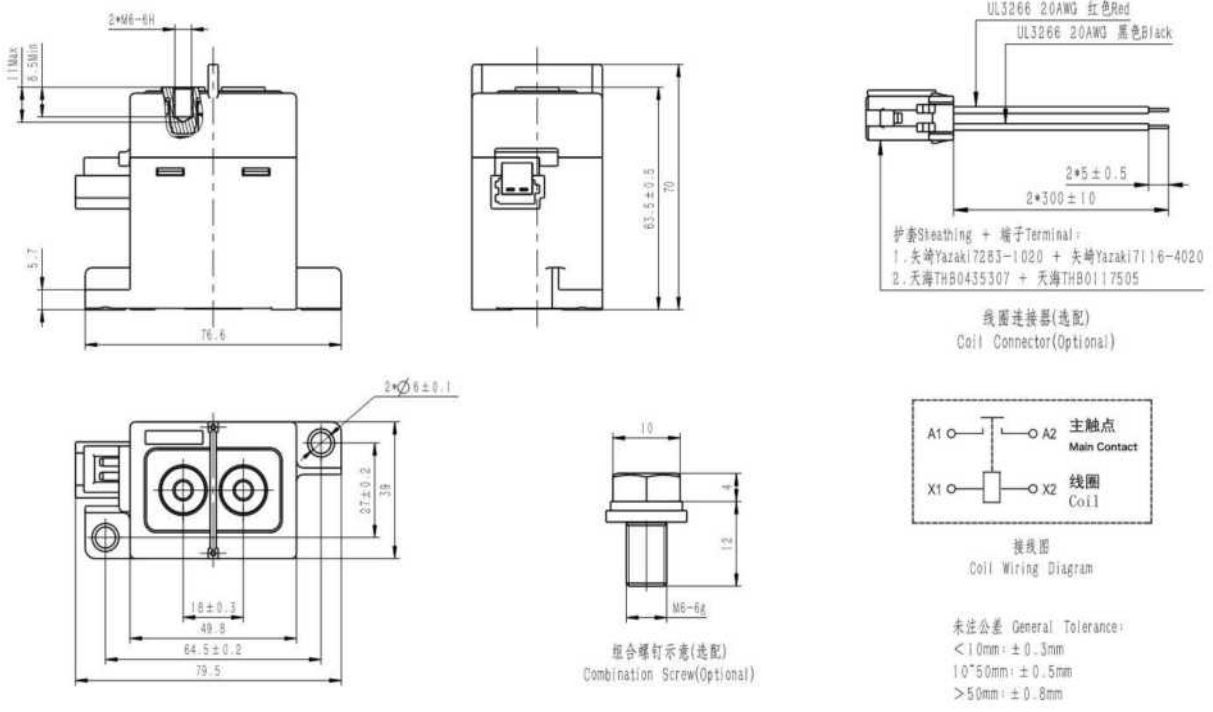

### HCF100B/□-□-HC1H

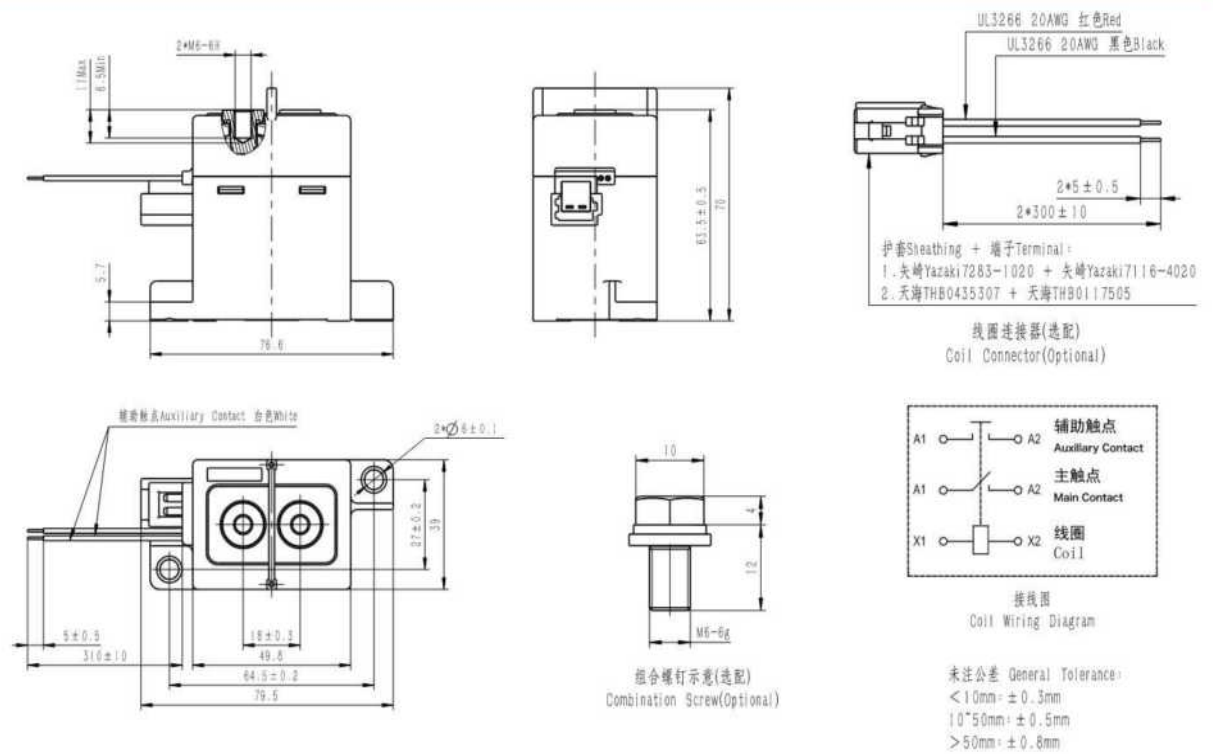



外形尺寸图 OUTLINE DIMENSIONS

HCF150/□-□-HC1

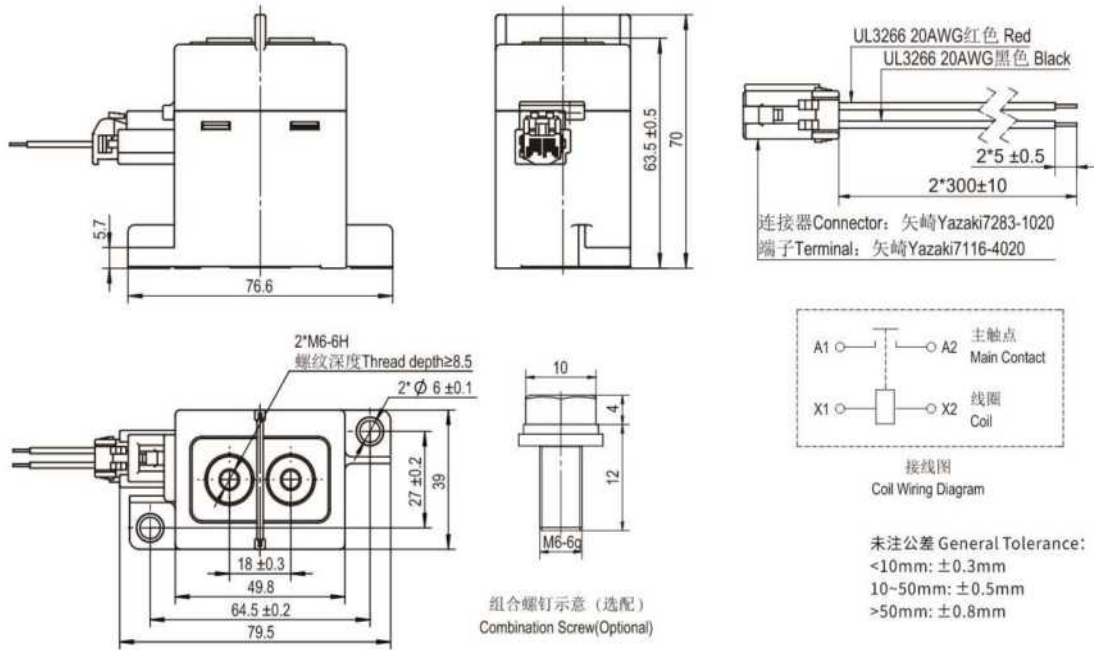

HCF150/□-□-HC1H

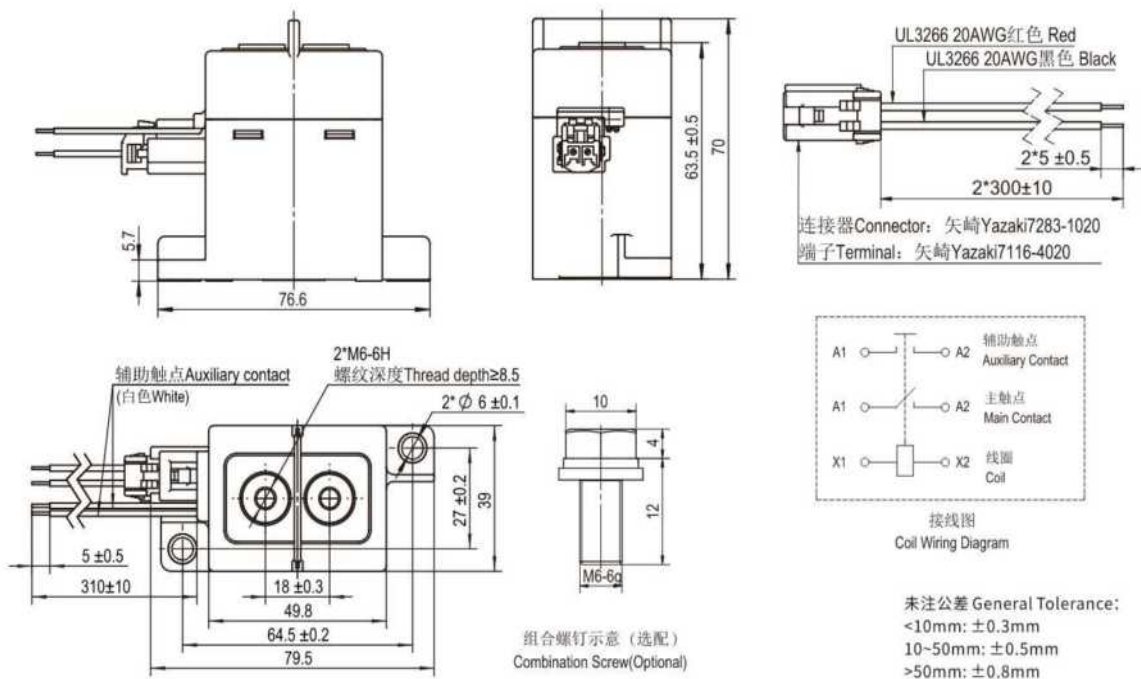

## 外形尺寸图 OUTLINE DIMENSIONS

### HCF200/□-□-HC1

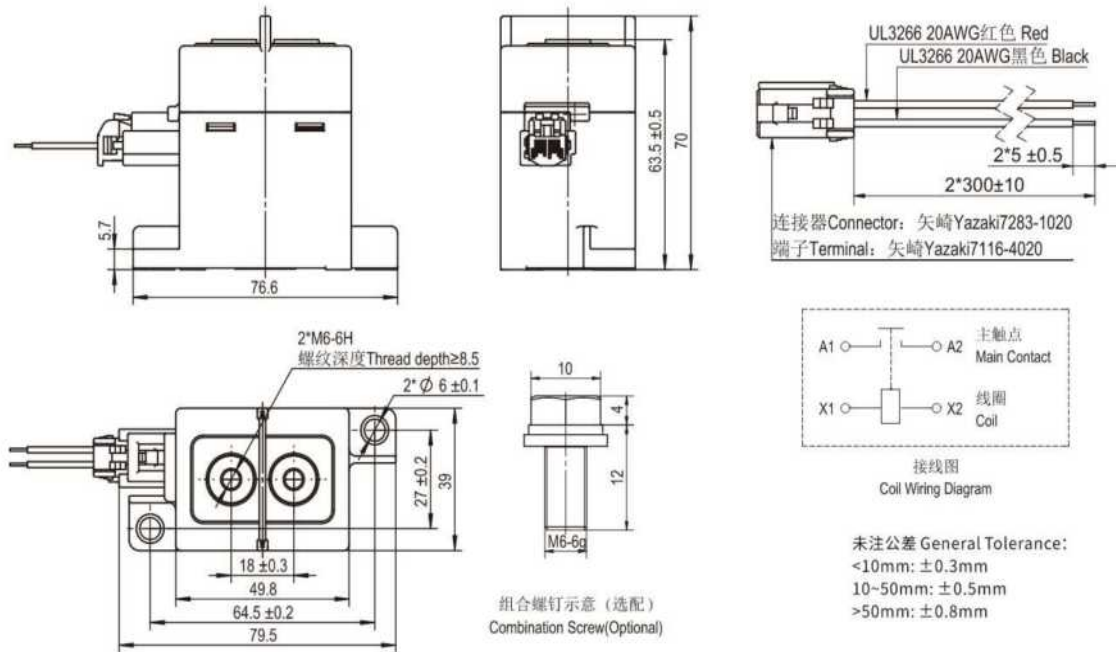

### HCF200/□-□-HC1H

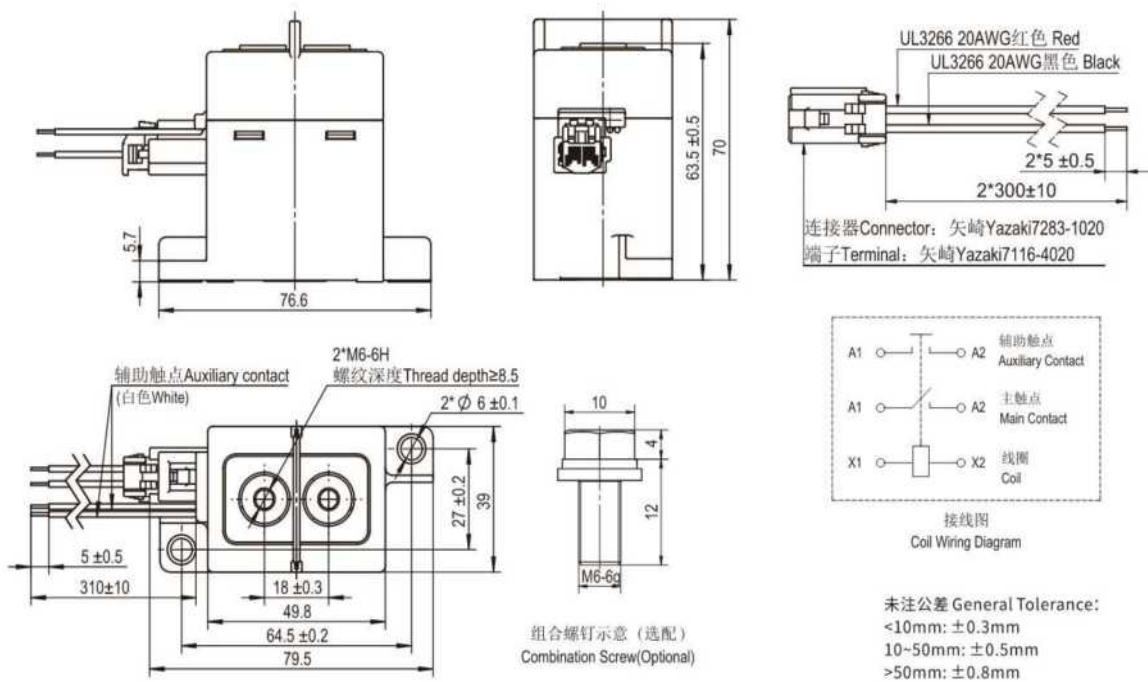

# 外形尺寸图 OUTLINE DIMENSIONS

## HCF250/□-□-HC1

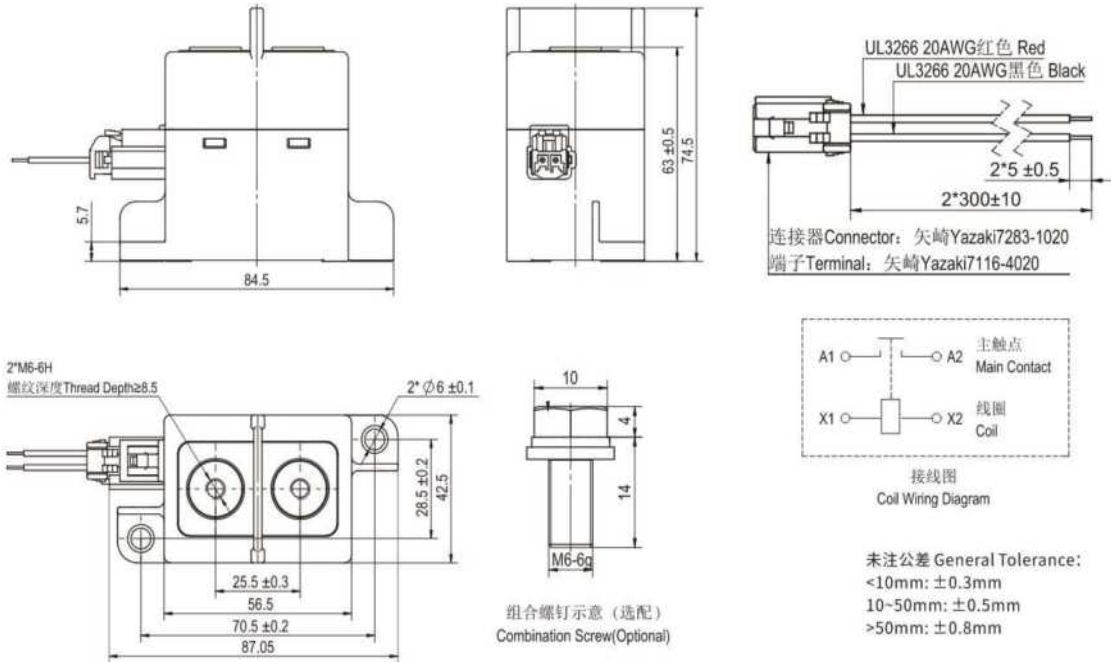

## HCF250/□-□-HC1H

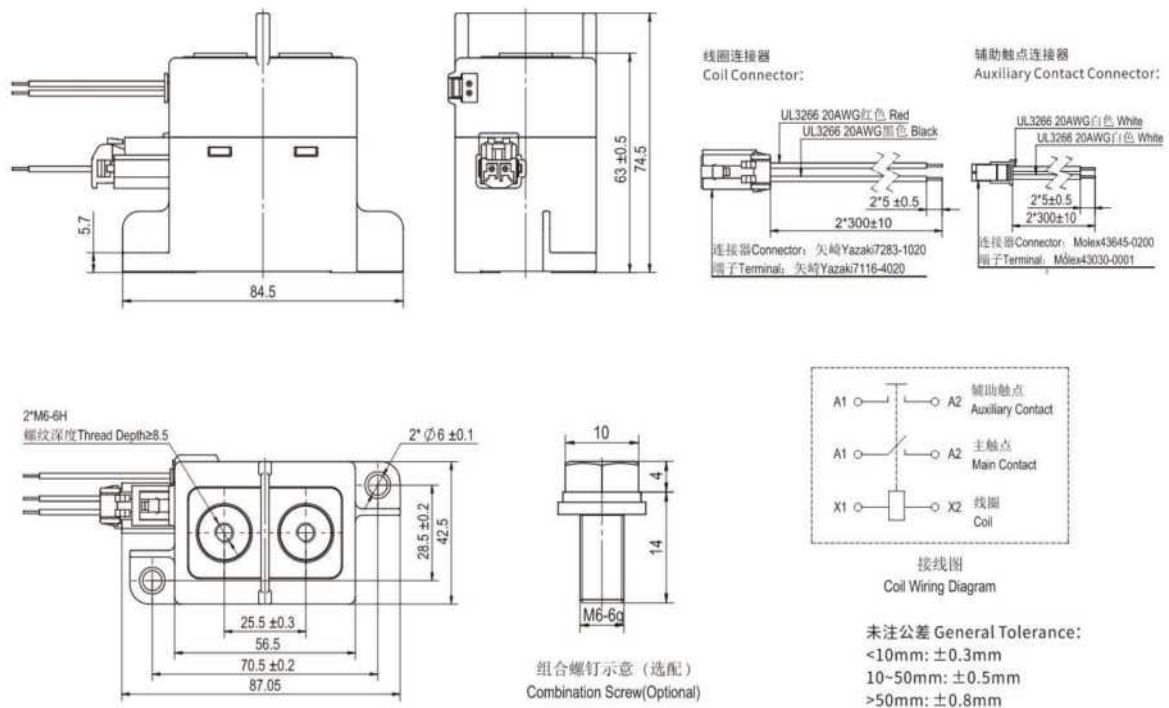

## 外形尺寸图 OUTLINE DIMENSIONS

### HCF250/□-□-HC1Y

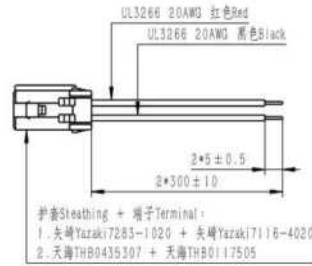
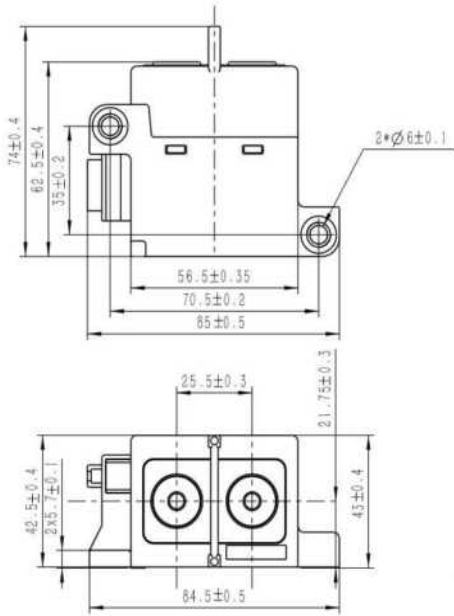

线圈连接器(选配)  
Coil Connector(Optional)

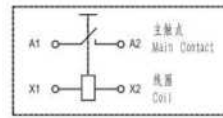

接线图  
Coil Wiring Diagram

公差 General Tolerance:  
< 10mm ± 0.3mm  
10~50mm ± 0.5mm  
> 50mm ± 0.8mm

### HCF250/□-□-HC1HY

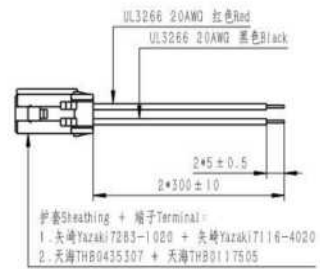
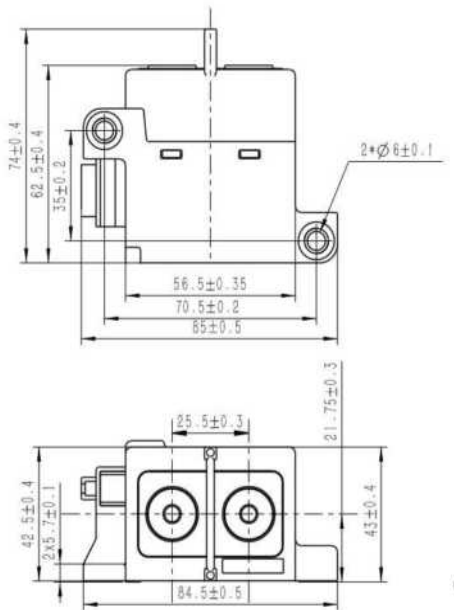

线圈连接器(选配)  
Coil Connector(Optional)



辅助触点连接器(选配)  
Auxiliary Contact Connector(Optional)

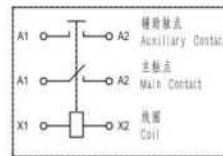

接线图  
Coil Wiring Diagram

公差 General Tolerance:  
< 10mm ± 0.3mm  
10~50mm ± 0.5mm  
> 50mm ± 0.8mm

## 外形尺寸图 OUTLINE DIMENSIONS

### HCF250B/□-□-HC1

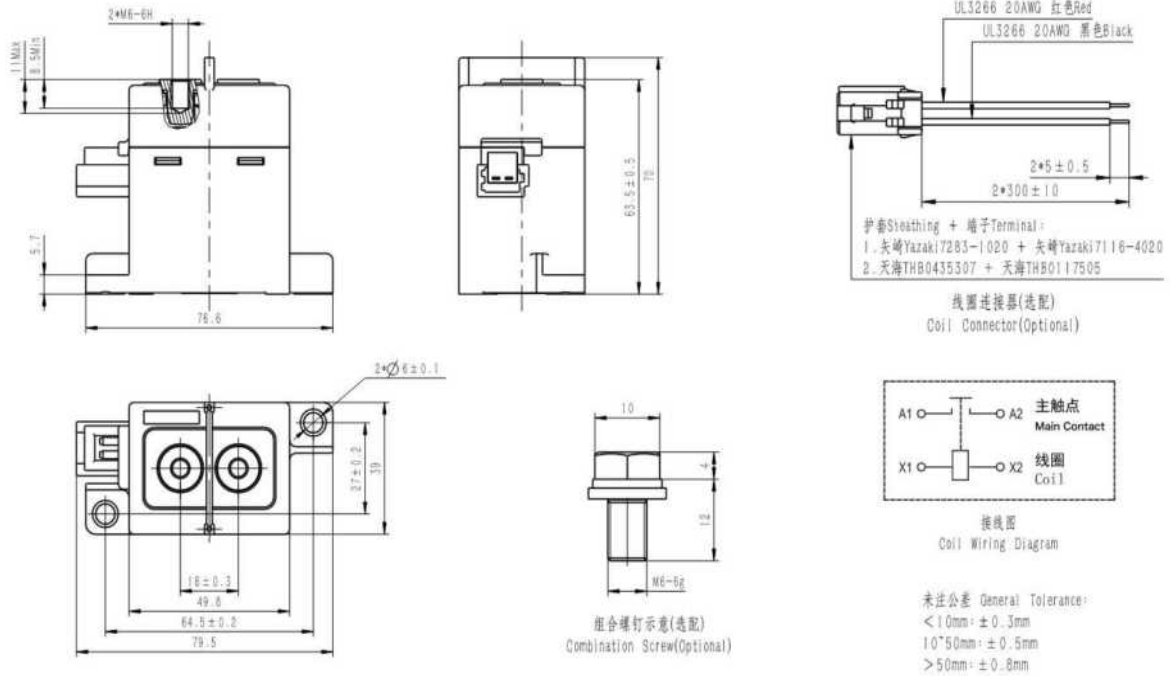

### HCF250B/□-□-HC1H

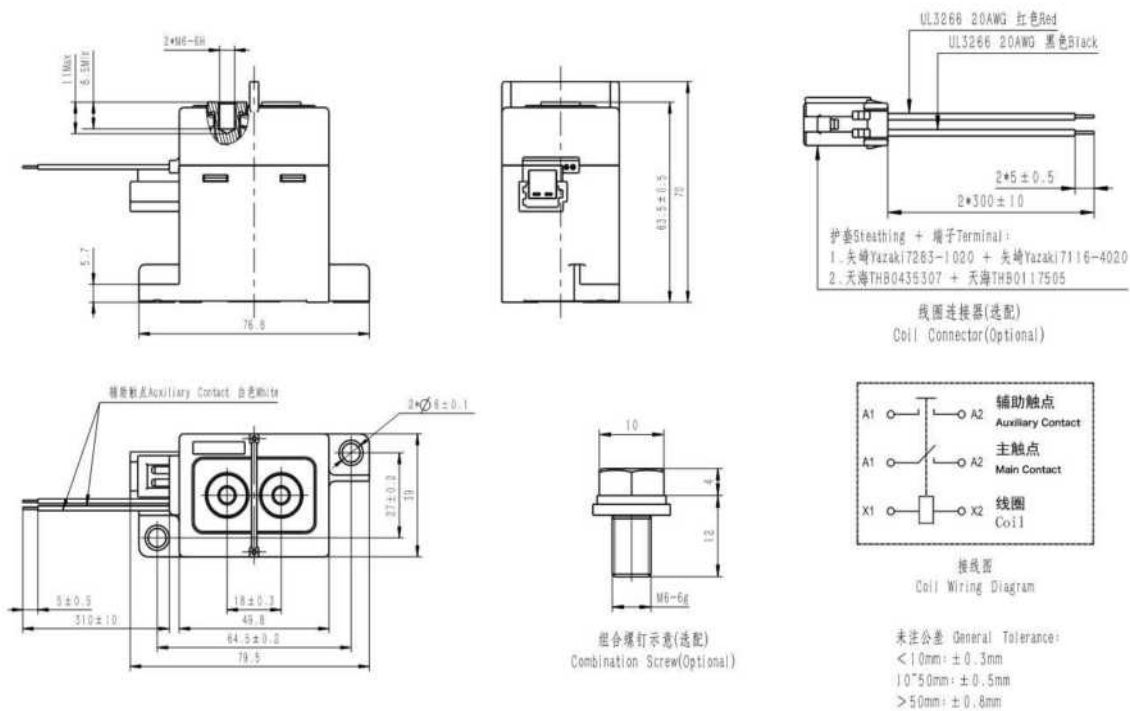

## 外形尺寸图 OUTLINE DIMENSIONS

### HCF250C/□-□-HC1

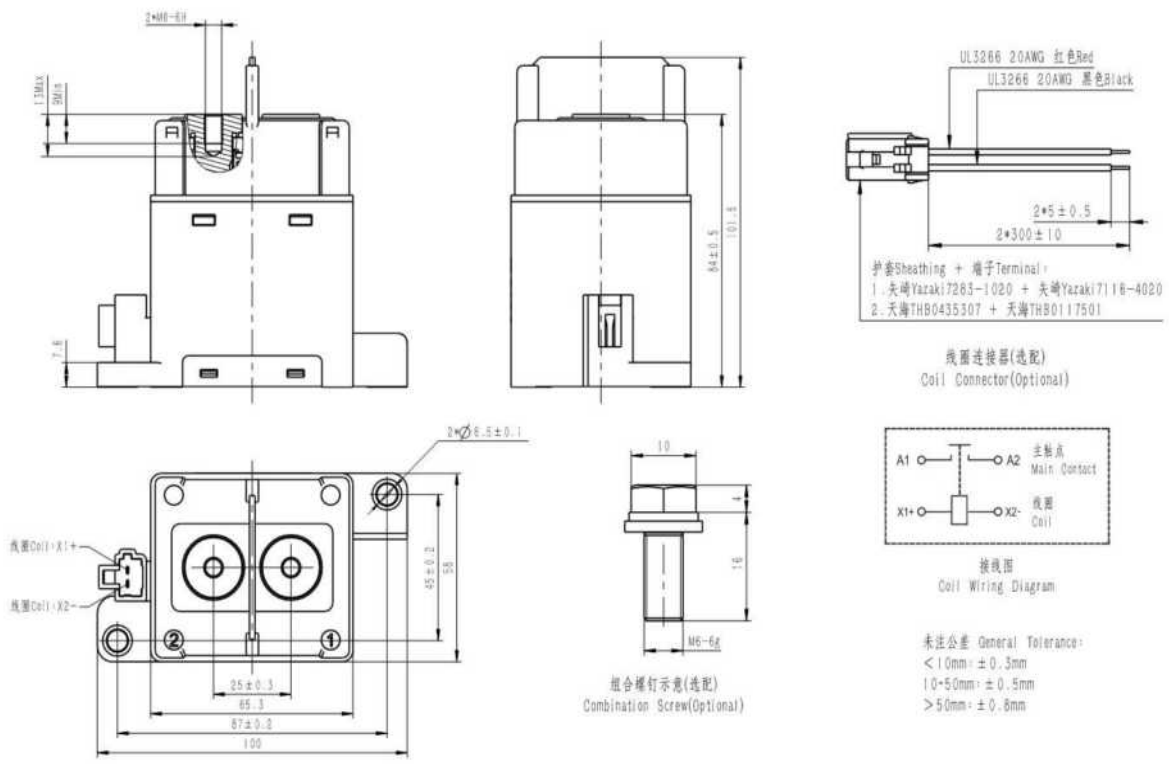

### HCF250C/□-□-HC1H

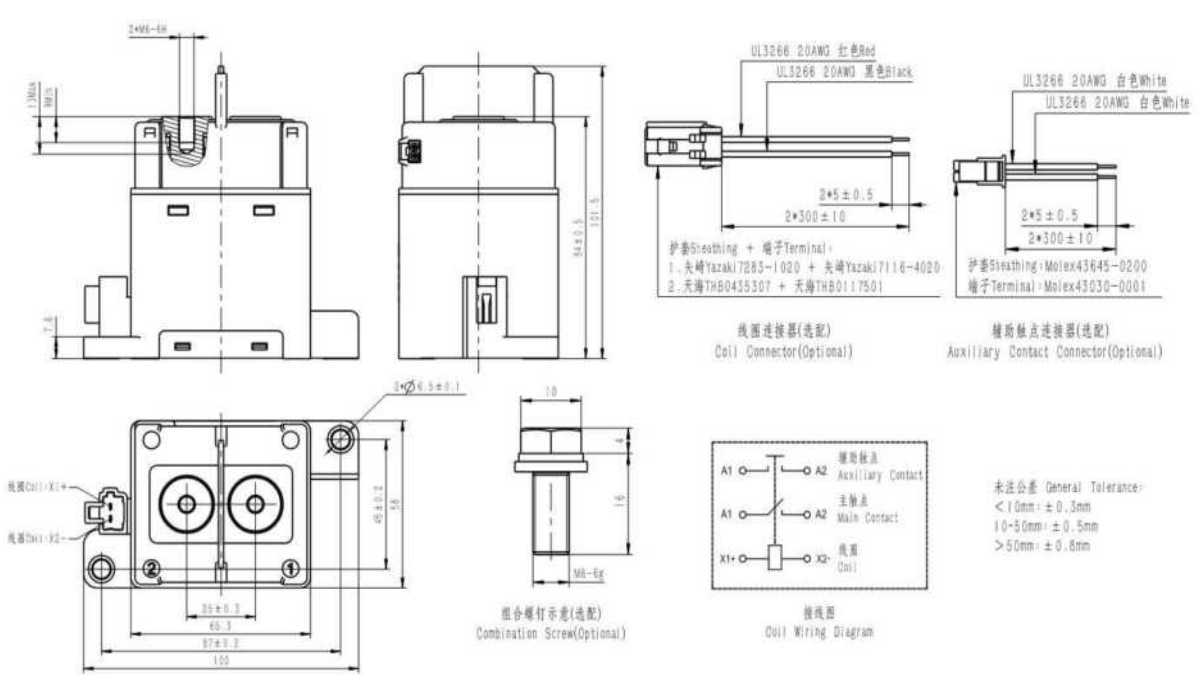

外形尺寸图 OUTLINE DIMENSIONS

HCF250D/□-□-HC1

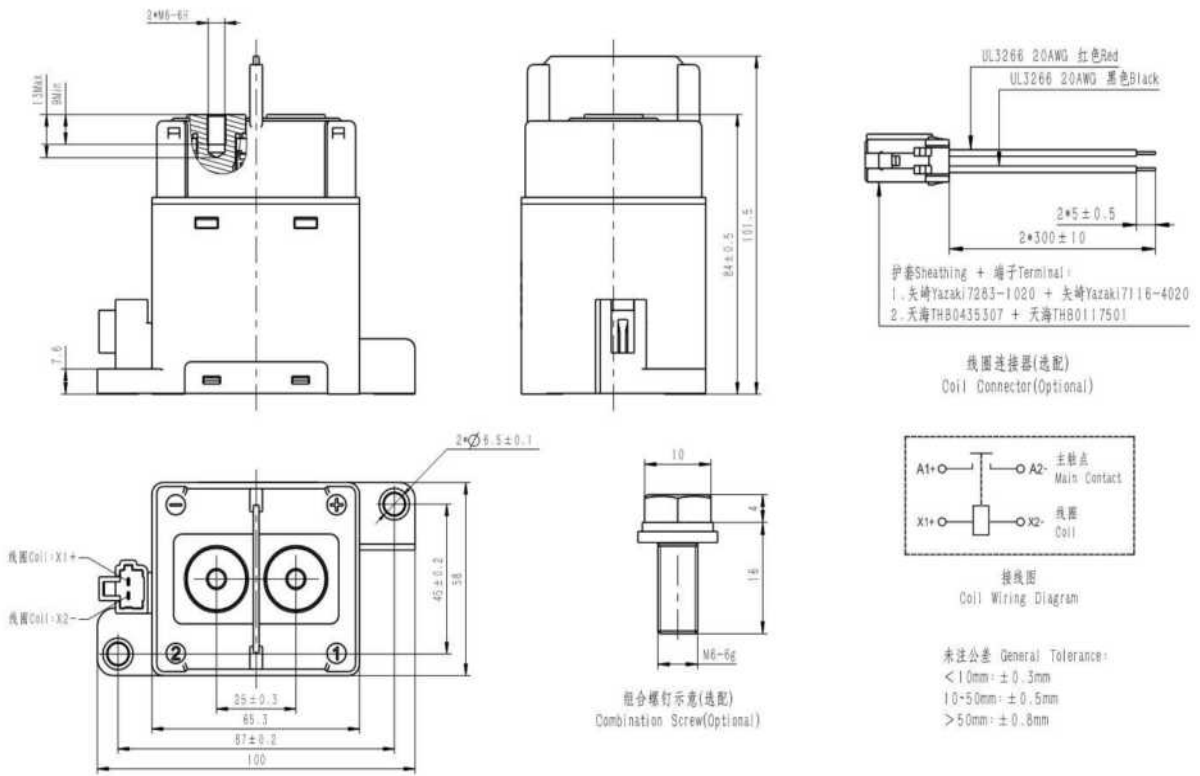

HCF250D/□-□-HC1H

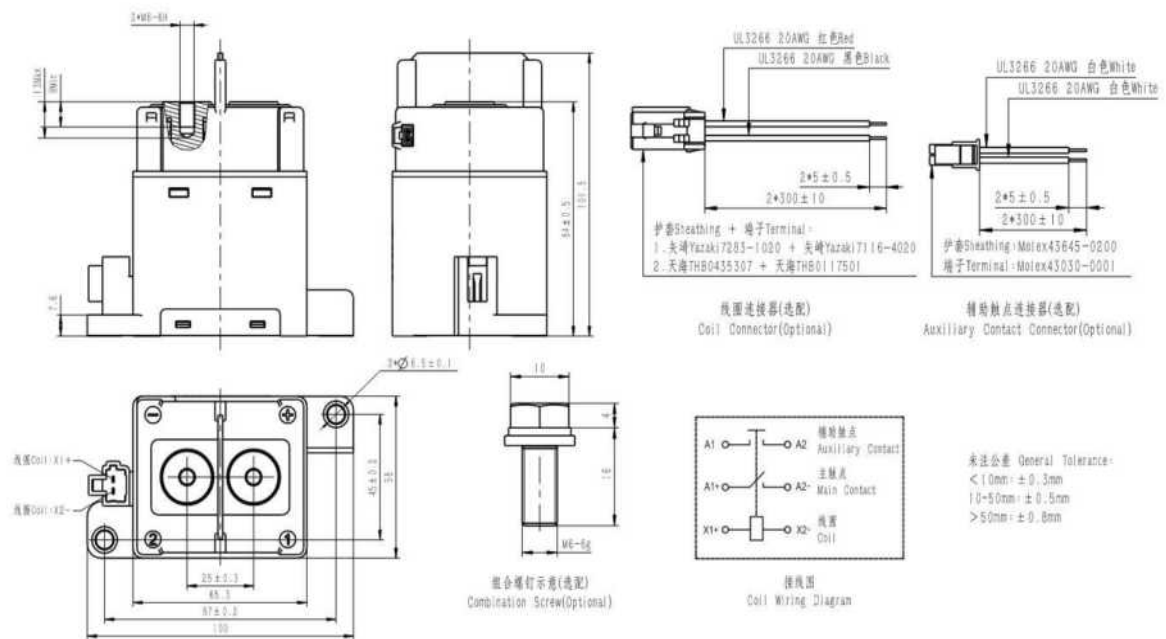

外形尺寸图 OUTLINE DIMENSIONS

HCF250E/□-□-HC2

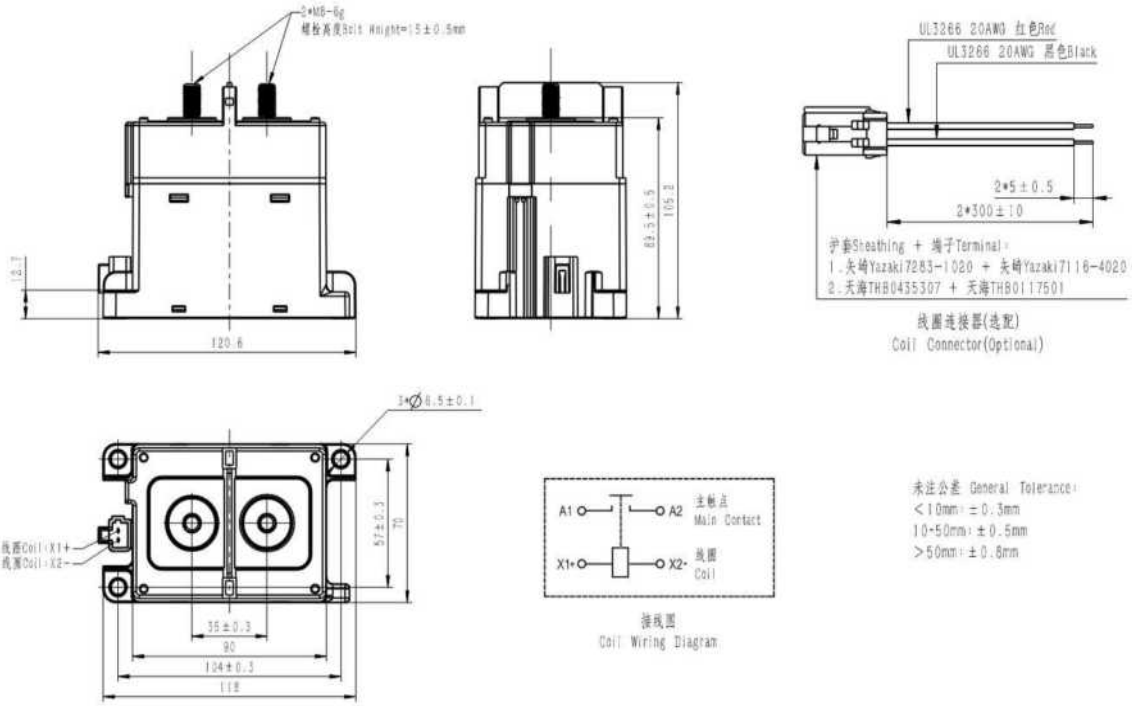

HCF250E/□-□-HC2H

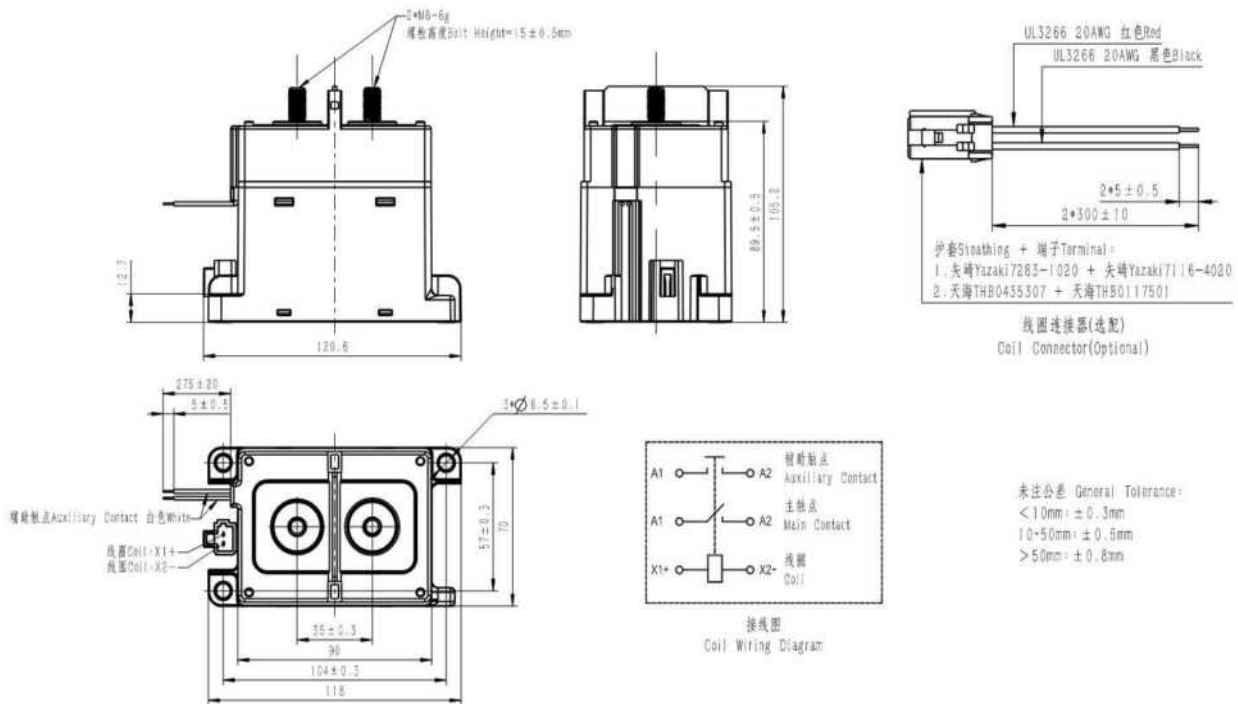



# 外形尺寸图 OUTLINE DIMENSIONS

## HCF300/□-□-HC1

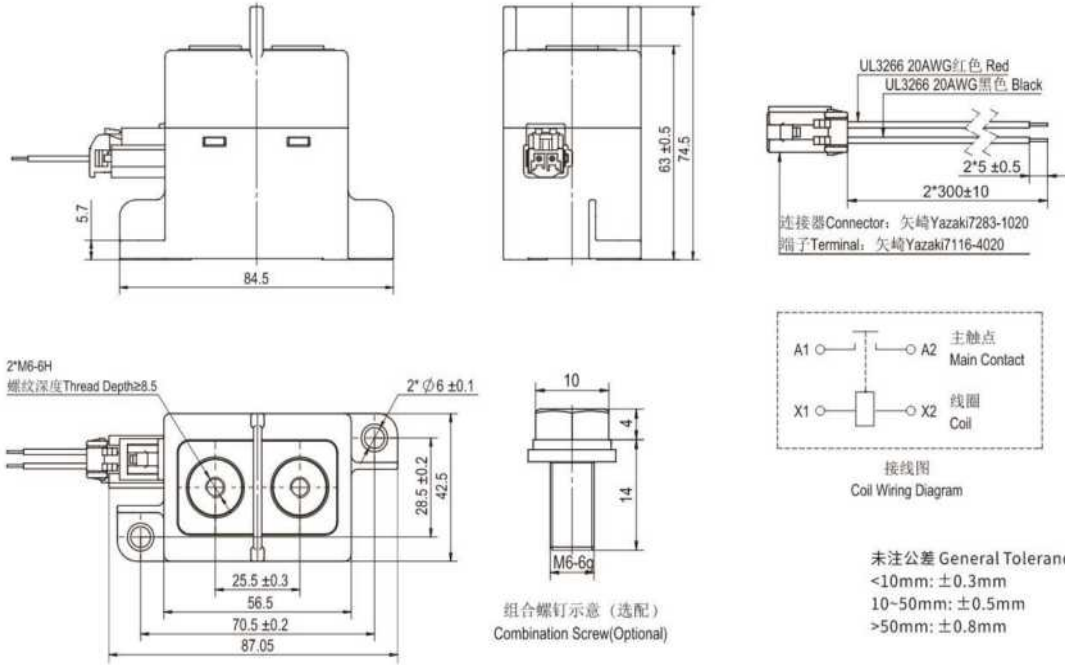

## HCF300/□-□-HC1H

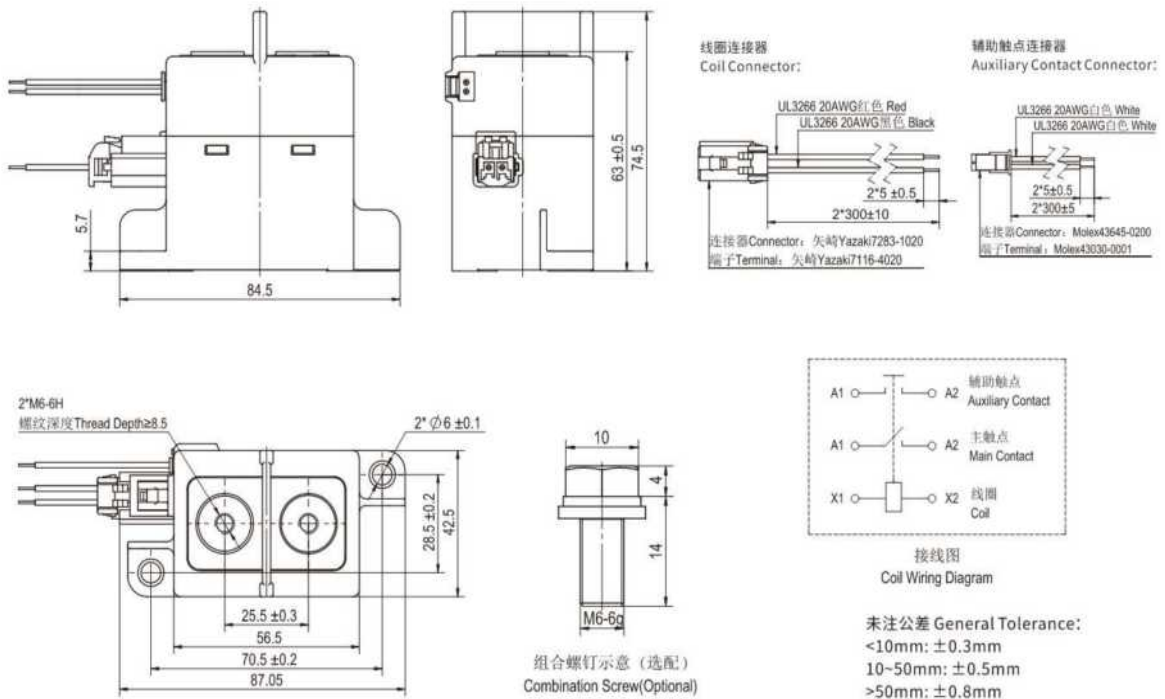

## 外形尺寸图 OUTLINE DIMENSIONS

### HCF300/□-□-HC1Y

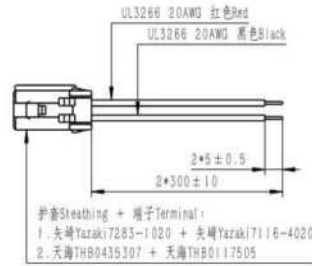
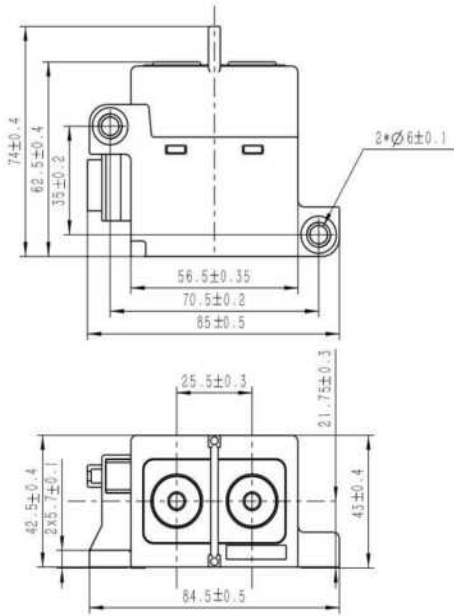

线圈连接器(选配)  
Coil Connector(Optional)

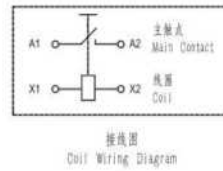

公差 General Tolerance:  
< 10mm ± 0.3mm  
10~50mm ± 0.5mm  
> 50mm ± 0.8mm

### HCF300/□-□-HC1Y

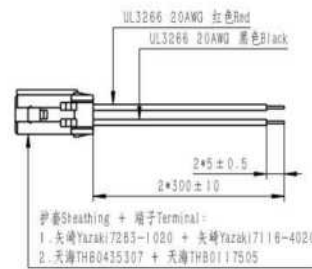
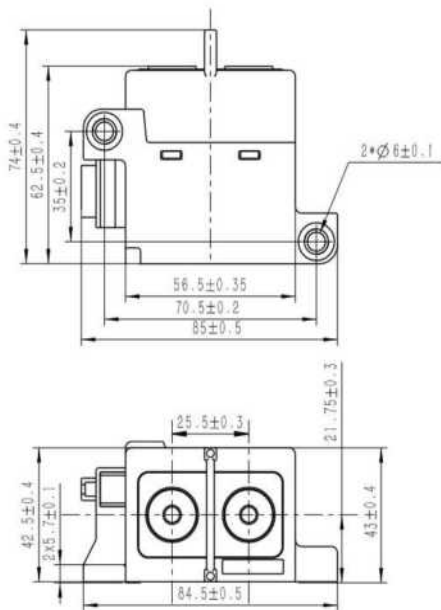

线圈连接器(选配)  
Coil Connector(Optional)



辅助触点连接器(选配)  
Auxiliary Contact Connector(Optional)

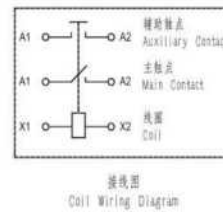

公差 General Tolerance:  
< 10mm ± 0.3mm  
10~50mm ± 0.5mm  
> 50mm ± 0.8mm

外形尺寸图 OUTLINE DIMENSIONS

HCF350/□-□-HC2

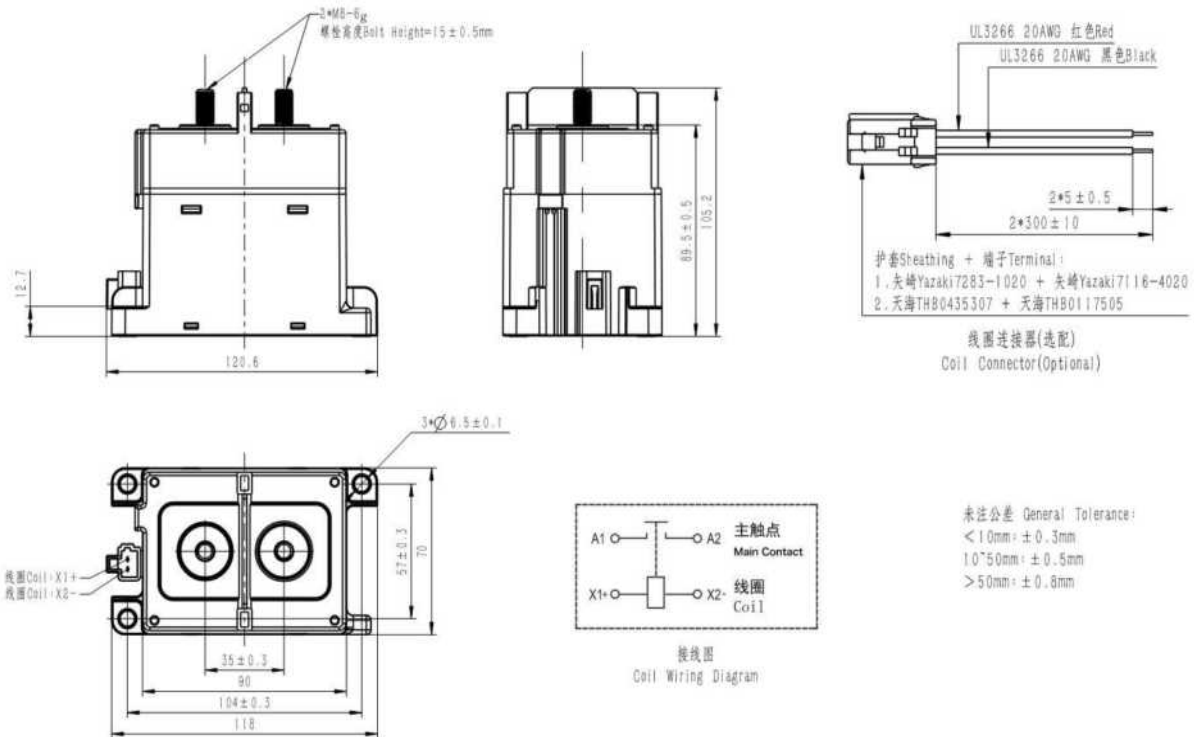

HCF350/□-□-HC2H

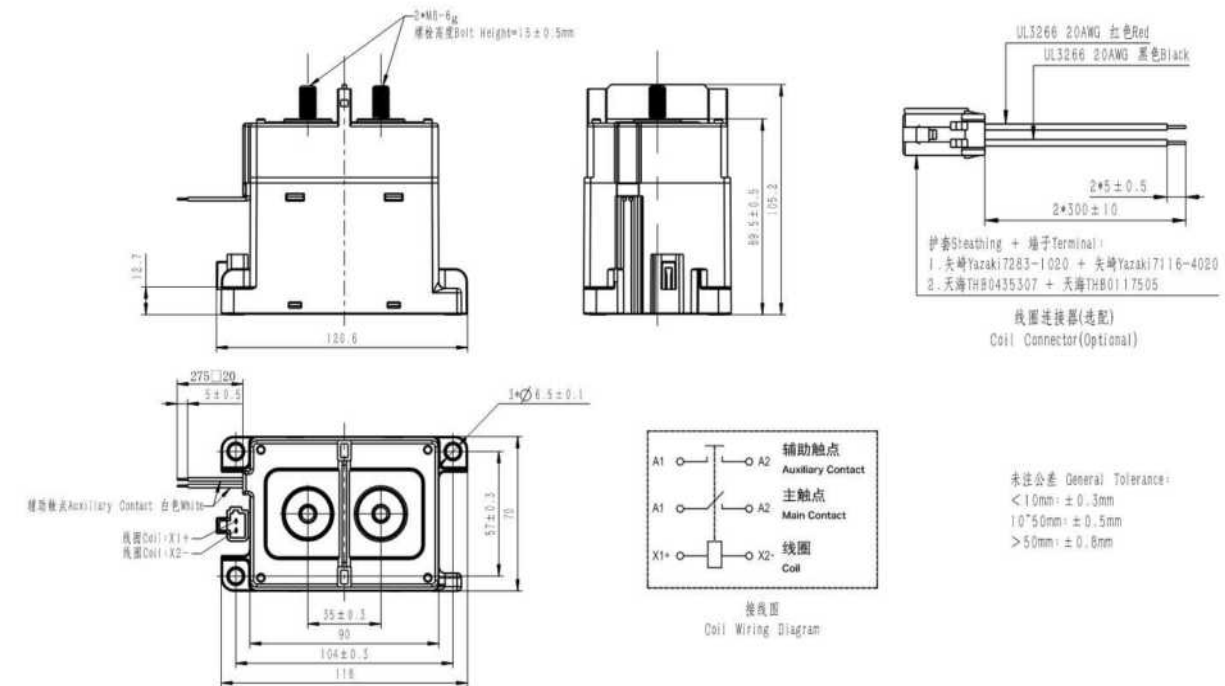

外形尺寸图 OUTLINE DIMENSIONS

HCF400/□-□-HC1

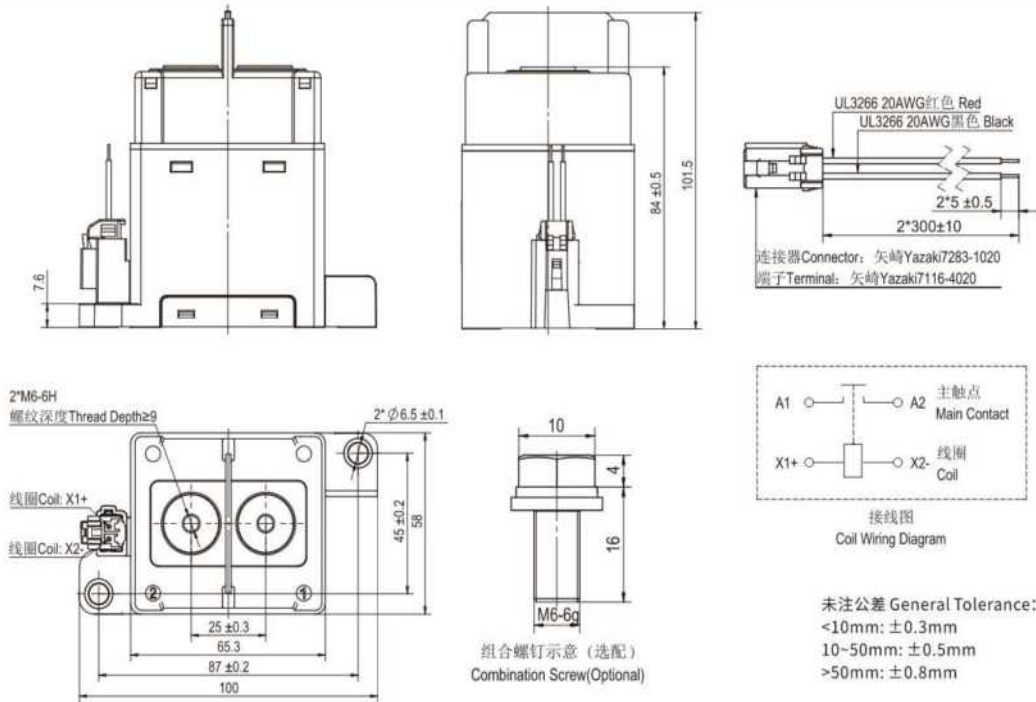

HCF400/□-□-HC1H

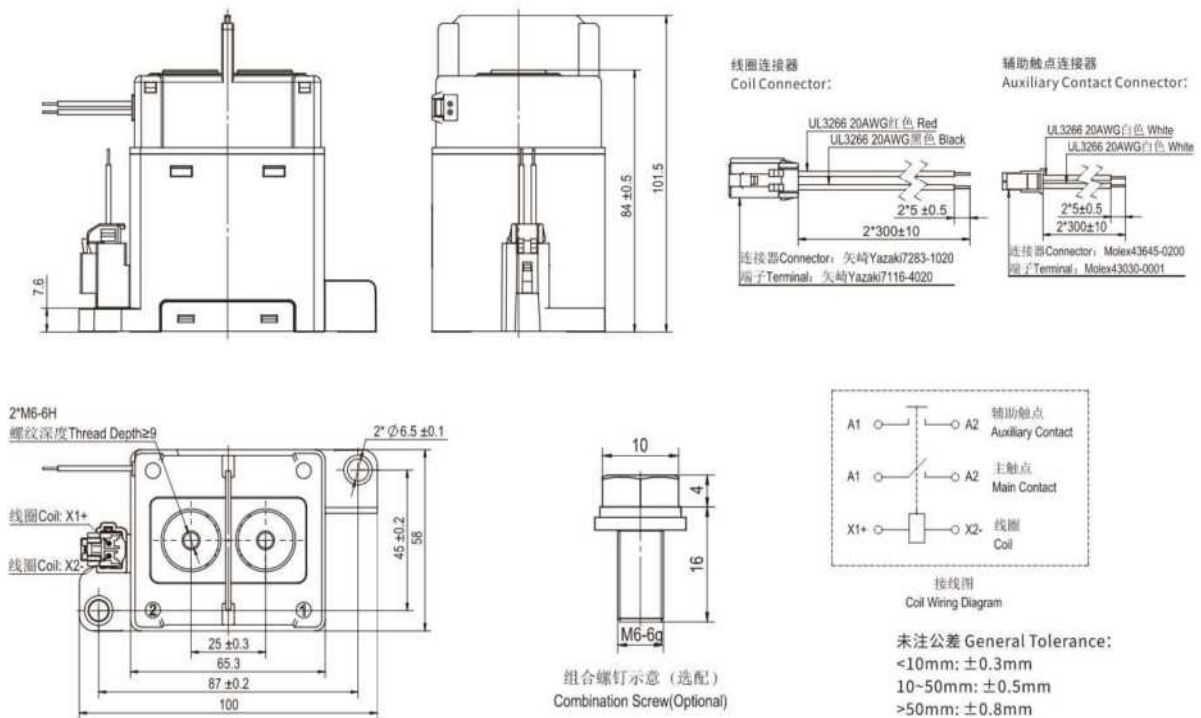

外形尺寸图 OUTLINE DIMENSIONS

HCF400B/□-□-HC1

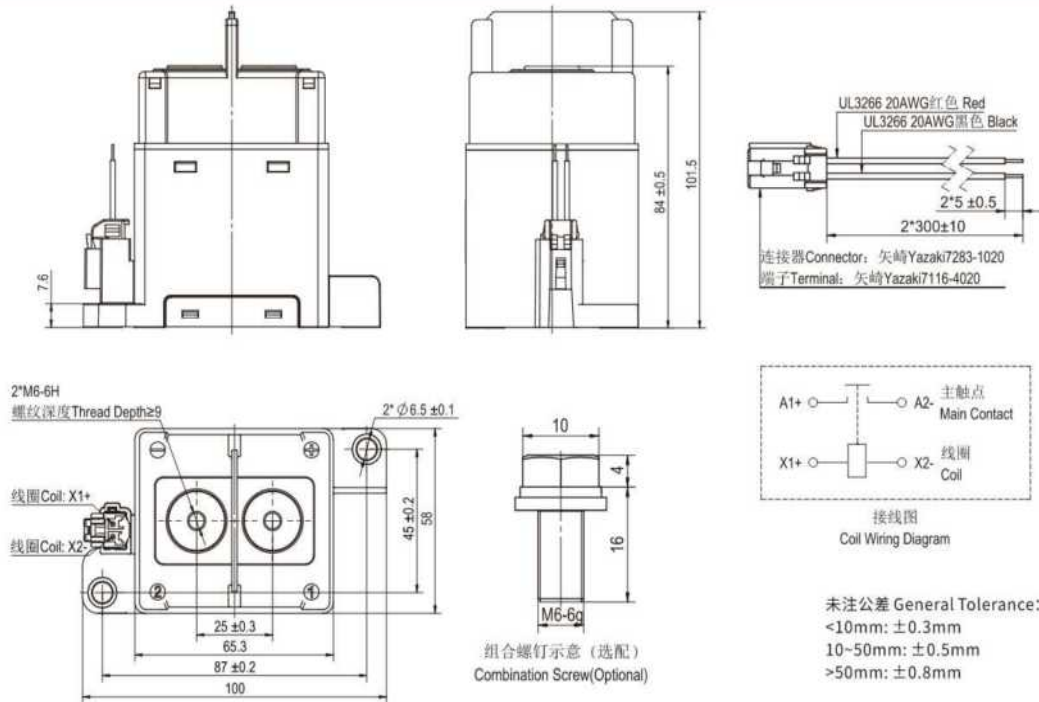

HCF400B/□-□-HC1H

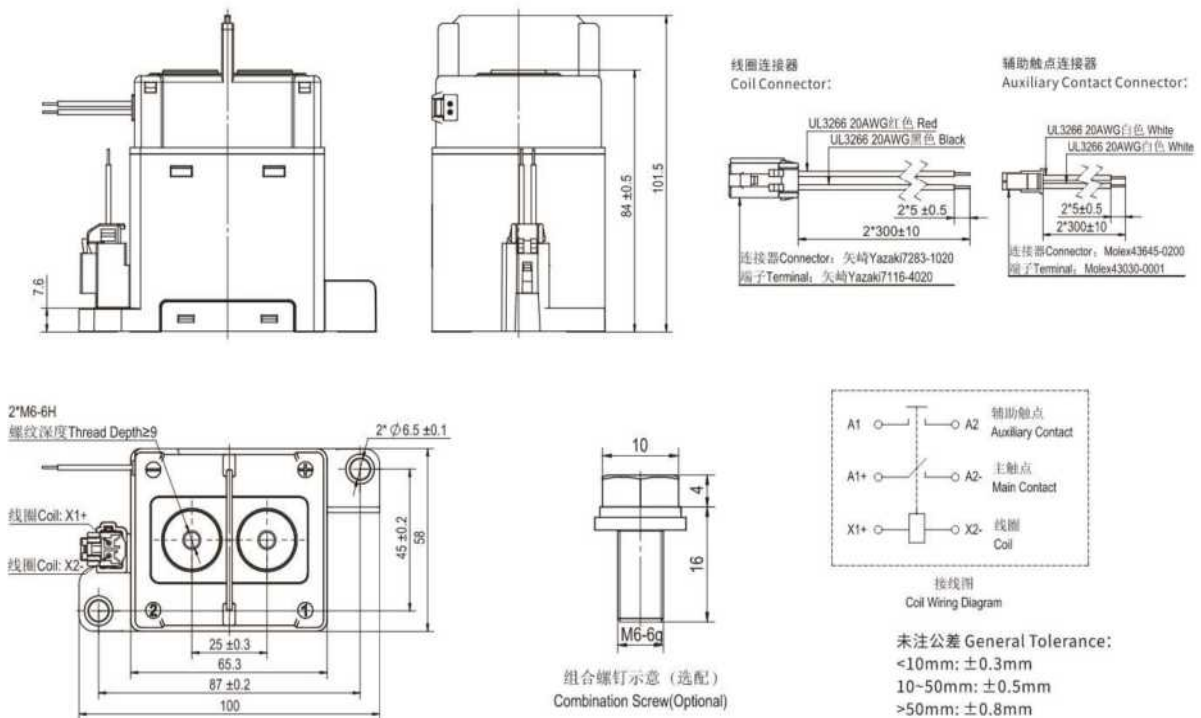

## 外形尺寸图 OUTLINE DIMENSIONS

### HCF400C/□-□-HC1

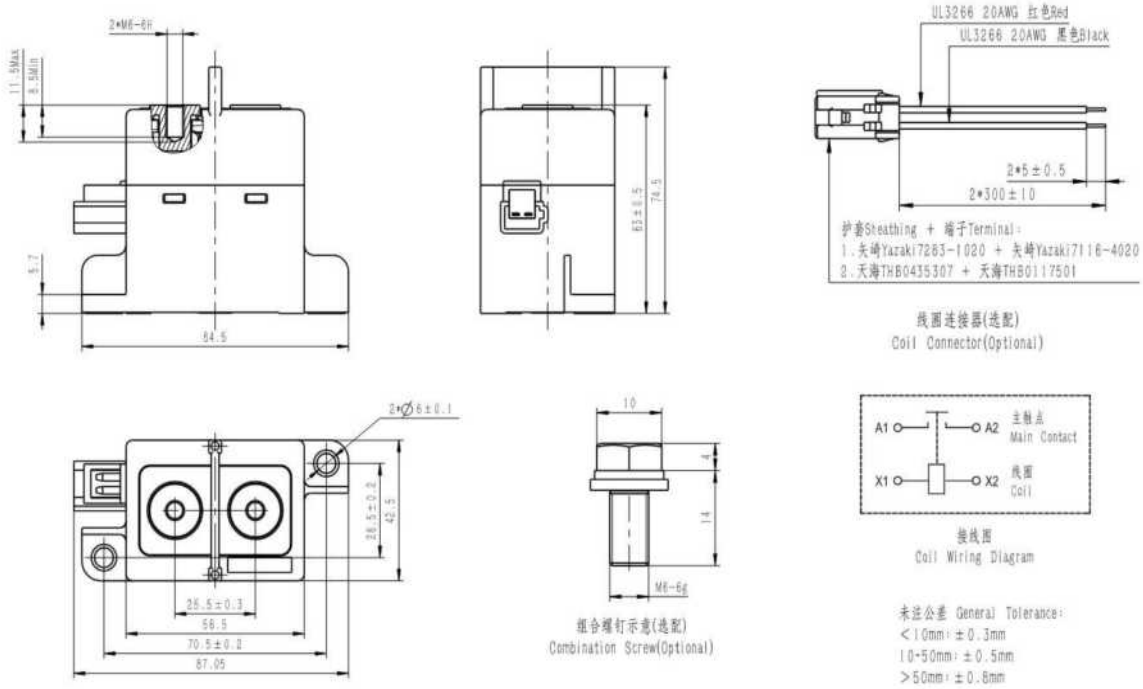

### HCF400C/□-□-HC1H

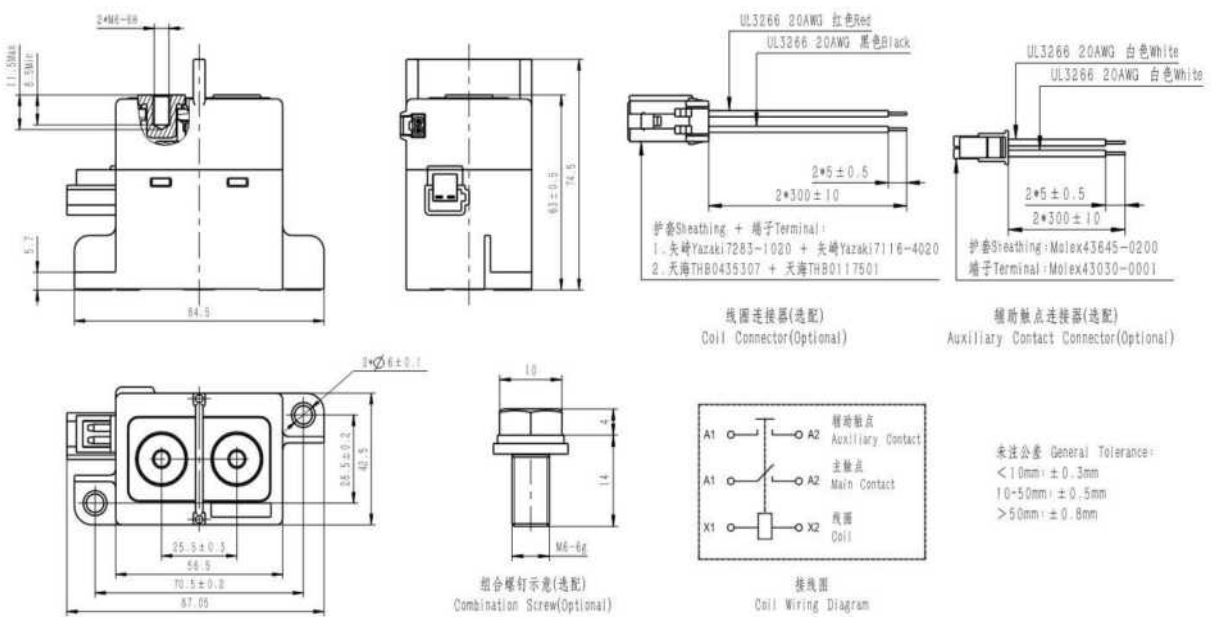

外形尺寸图 OUTLINE DIMENSIONS

HCF500/□-□-HC1

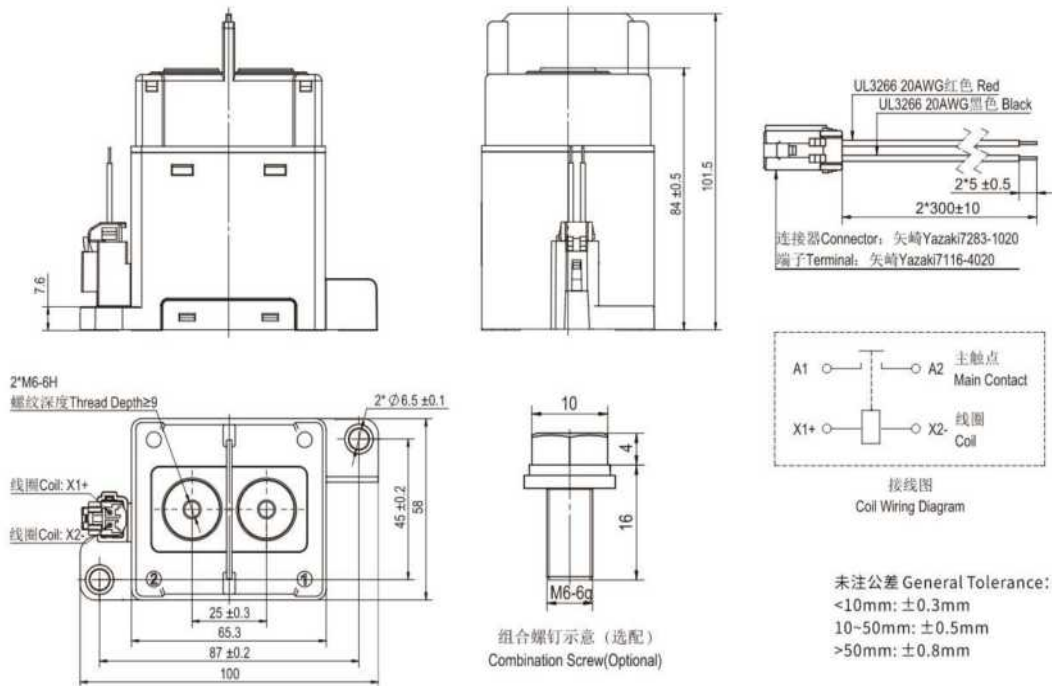

HCF500/□-□-HC1H

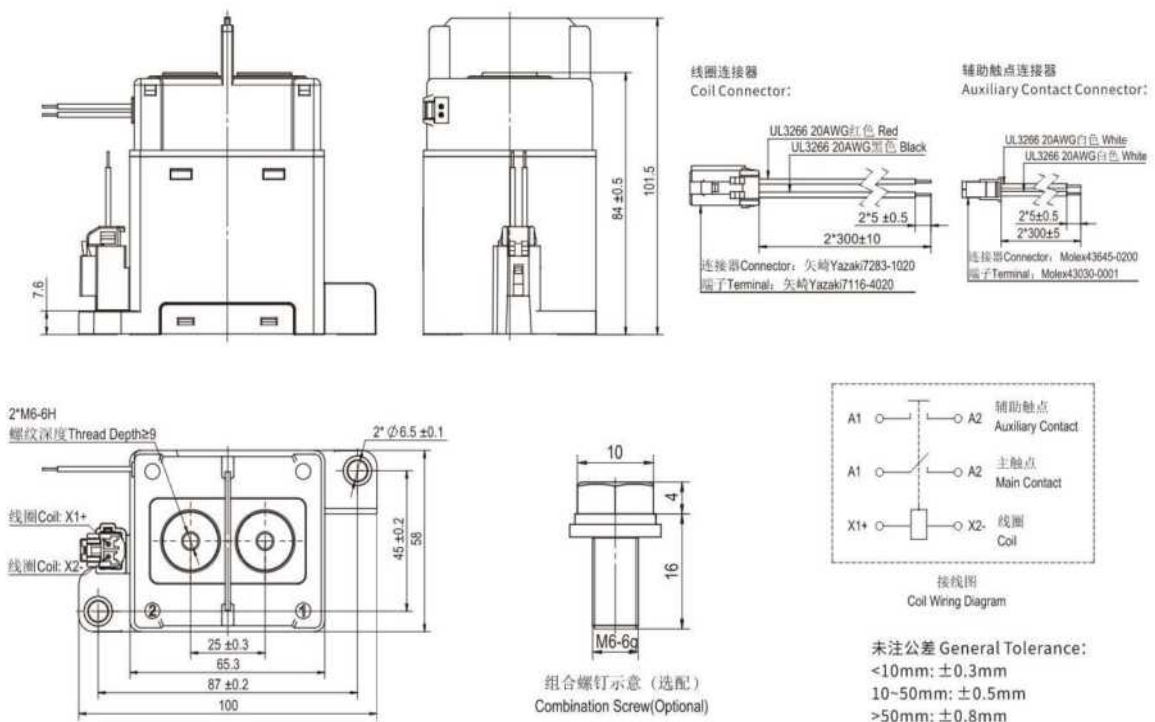

外形尺寸图 OUTLINE DIMENSIONS

HCF500B/□-□-HC1

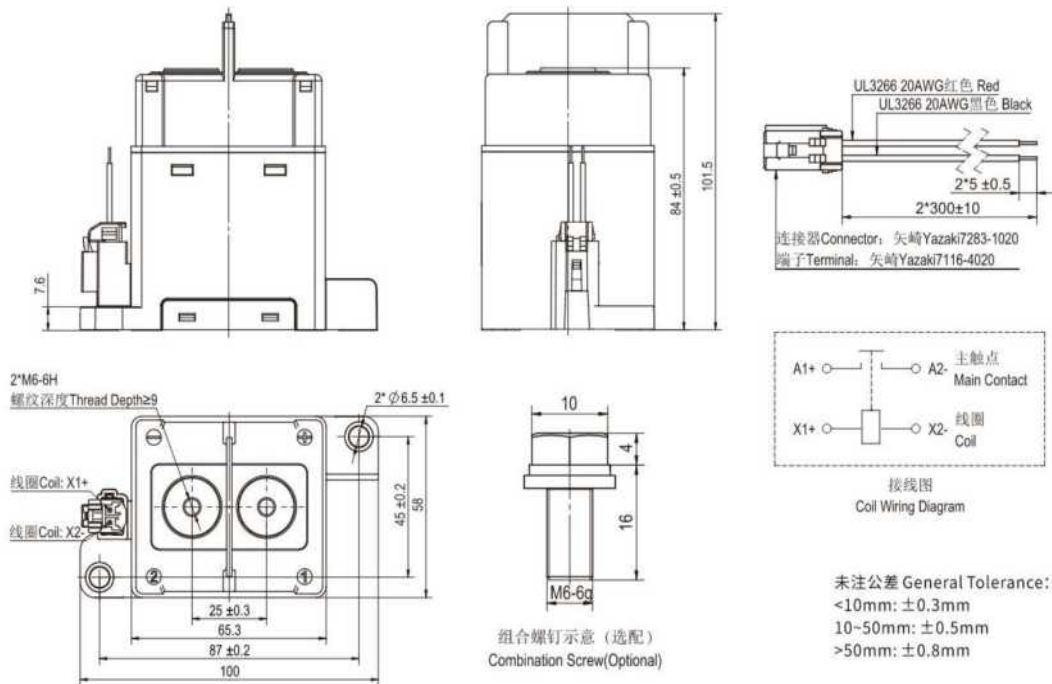

HCF500B/□-□-HC1H

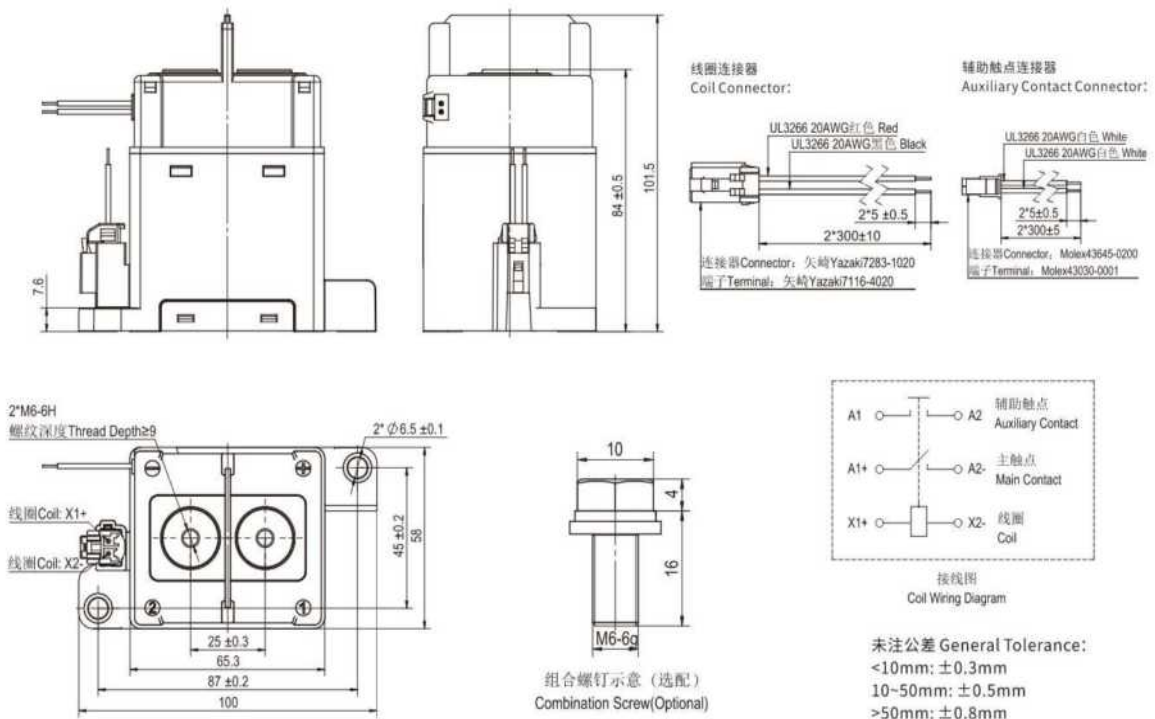



## 外形尺寸图 OUTLINE DIMENSIONS

### HCF600/□-□-HC2

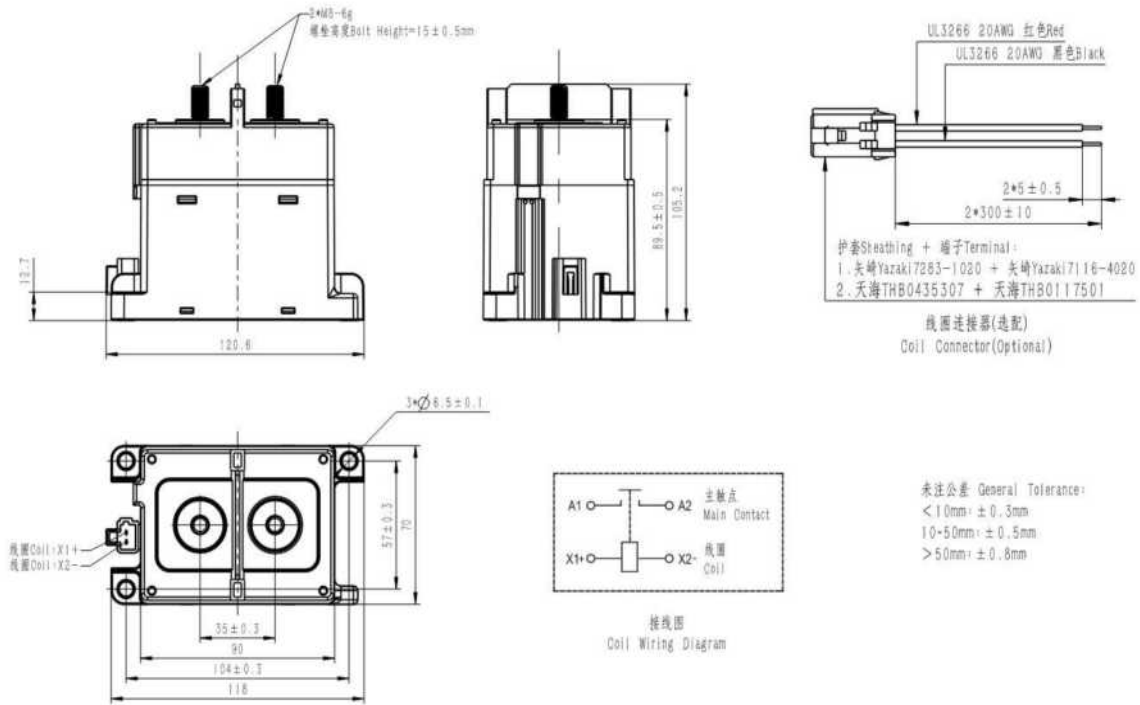

### HCF600/□-□-HC2H

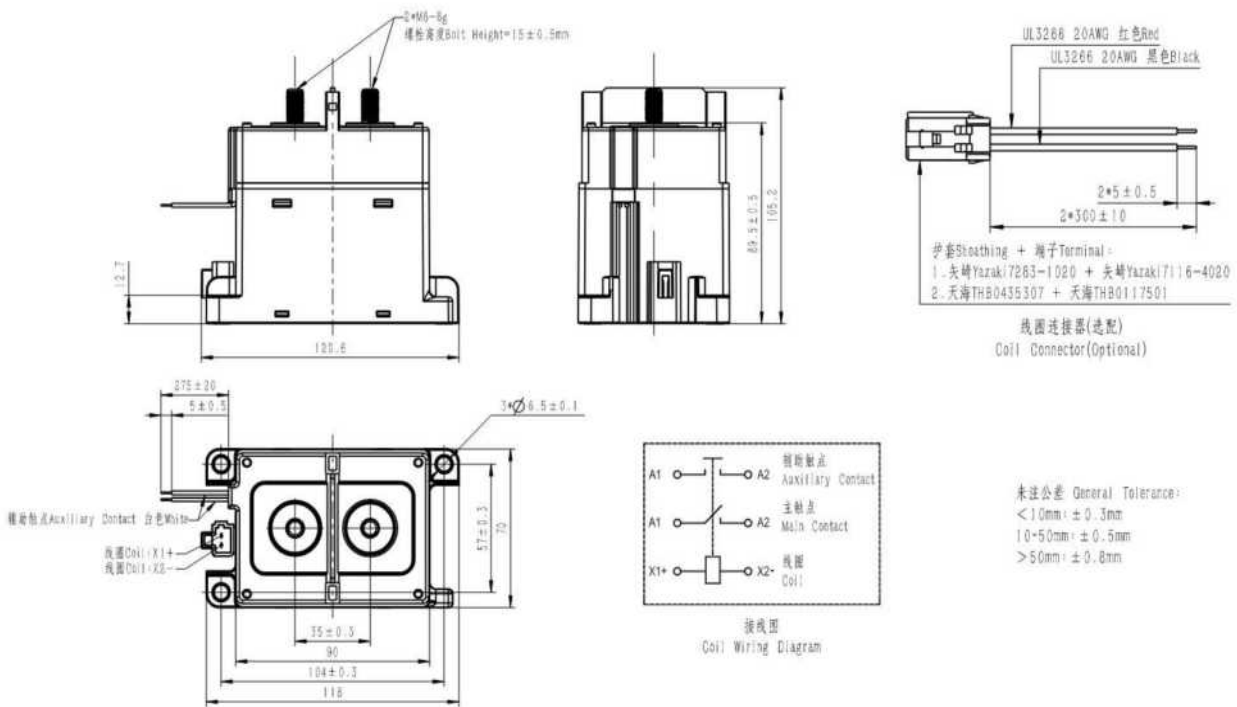

## 外形尺寸图 OUTLINE DIMENSIONS

### HCF700/□-□-HC2

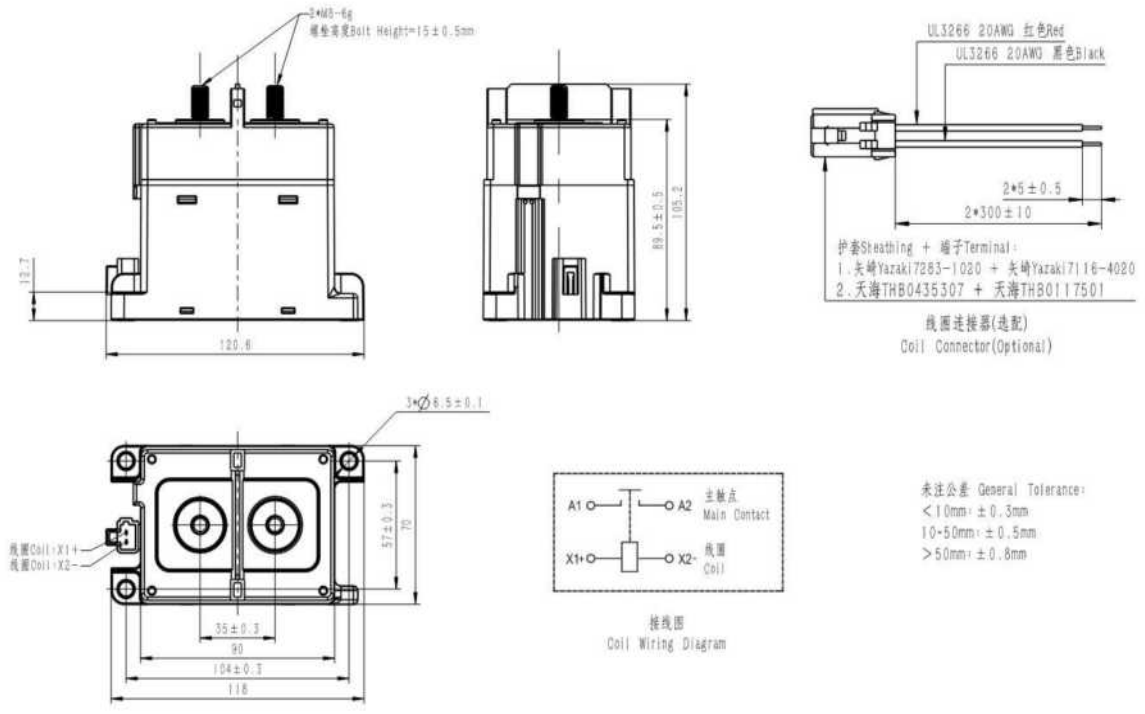

### HCF700/□-□-HC2H

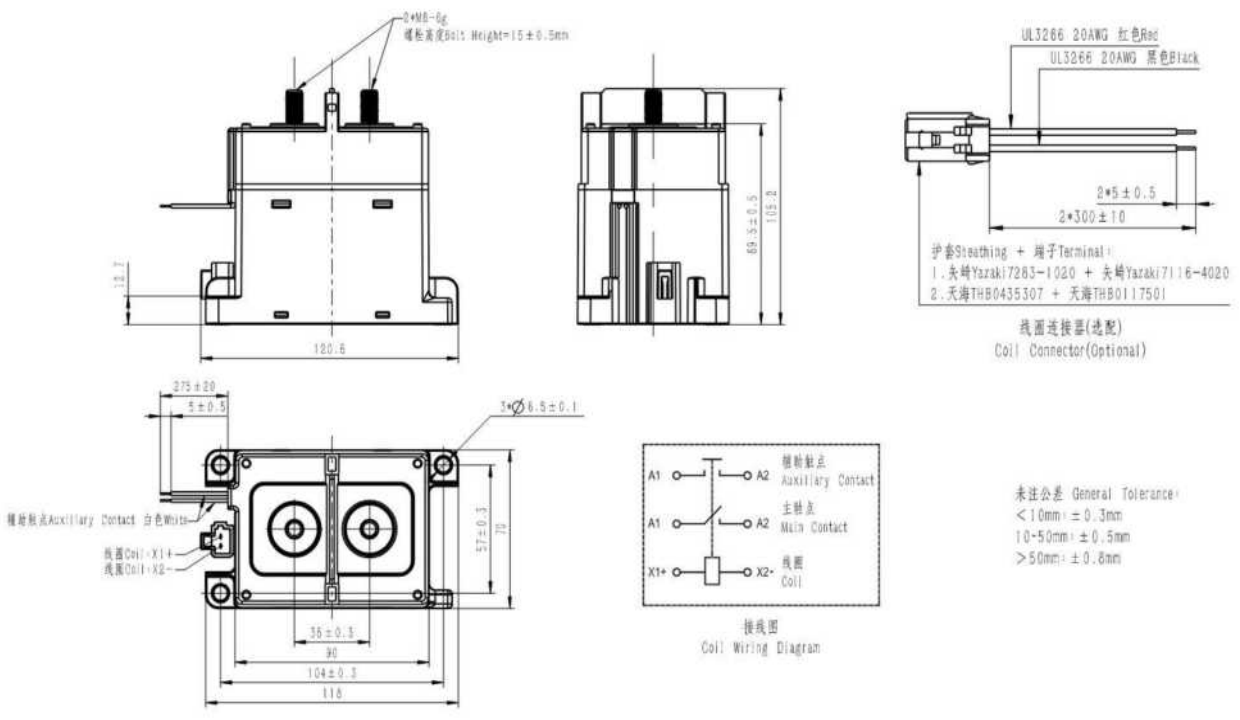

外形尺寸图 OUTLINE DIMENSIONS

HCF800A/□-□-HC3

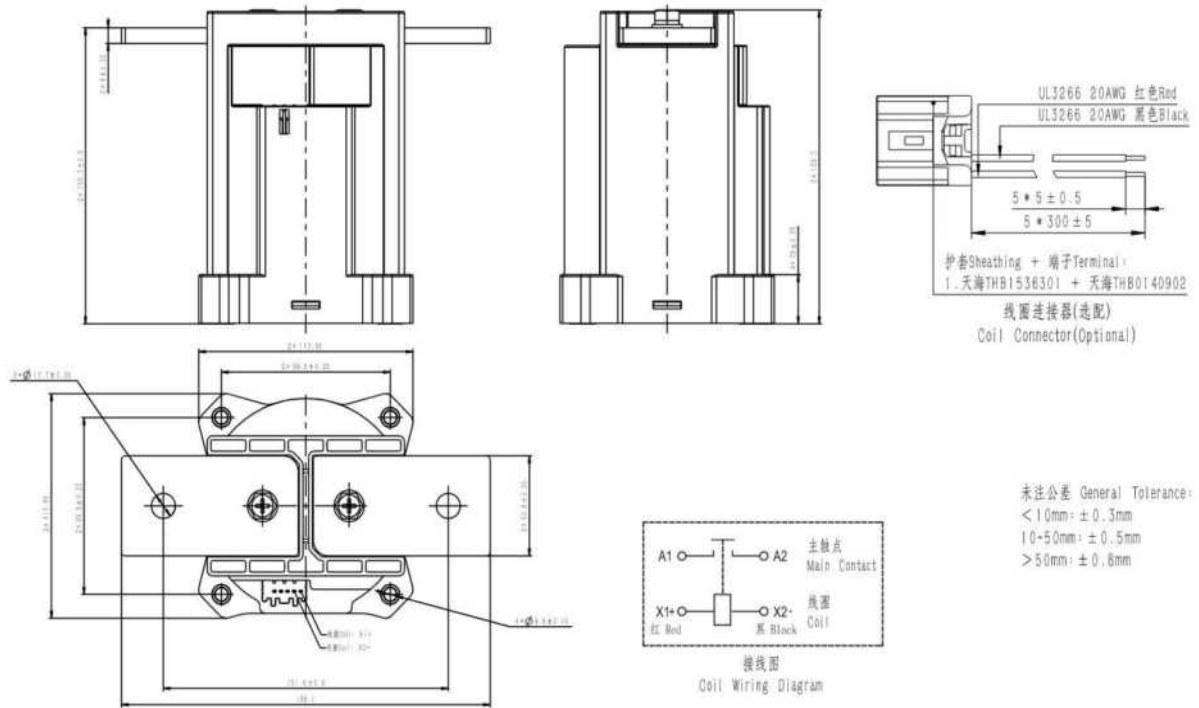

HCF800A/□-□-HC3Z

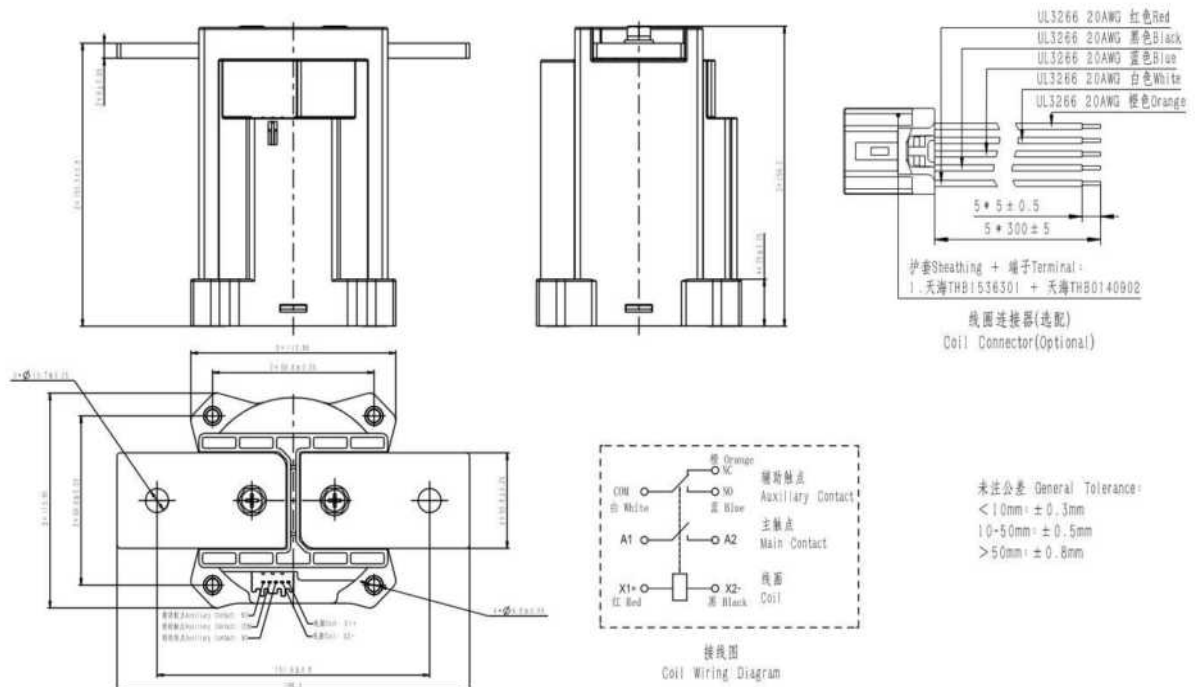

## 外形尺寸图 OUTLINE DIMENSIONS

HCF800B/□-□-HC3

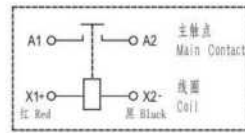
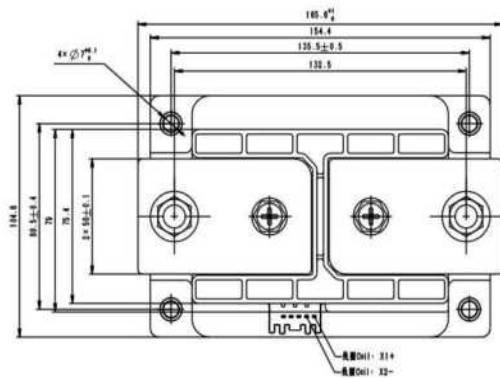
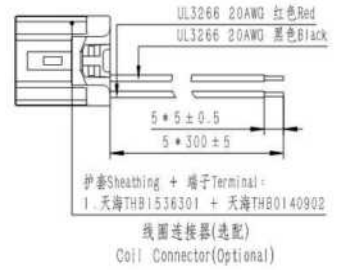
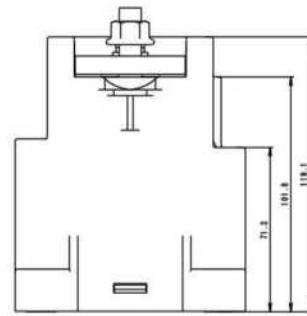
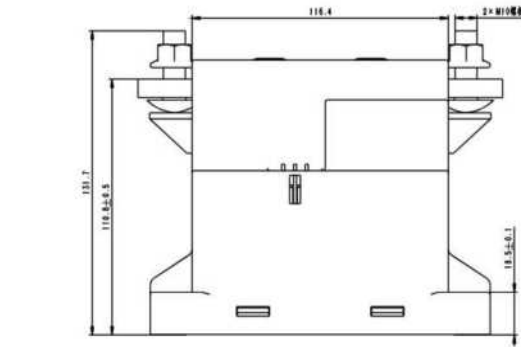

接线图  
Coil Wiring Diagram

未注公差 General Tolerance:  
 < 10mm: ± 0.3mm  
 10-50mm: ± 0.5mm  
 > 50mm: ± 0.8mm

HCF800B/□-□-HC3Z

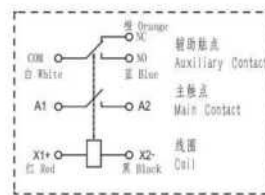
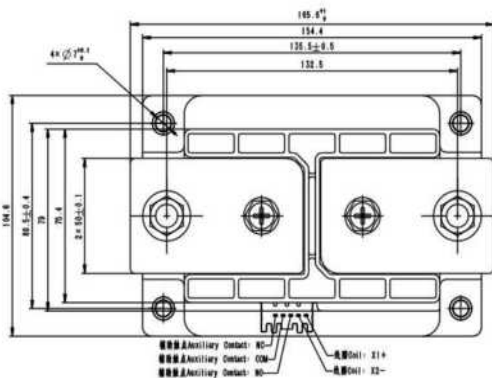
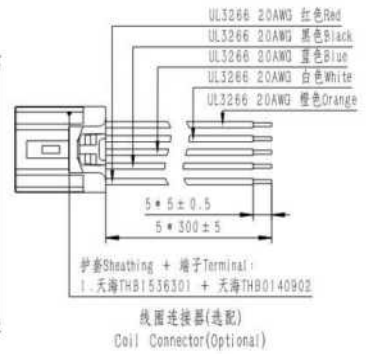
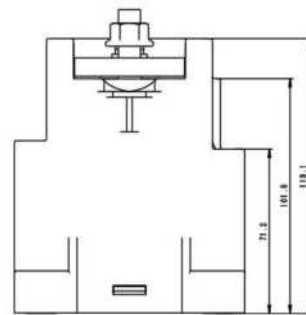
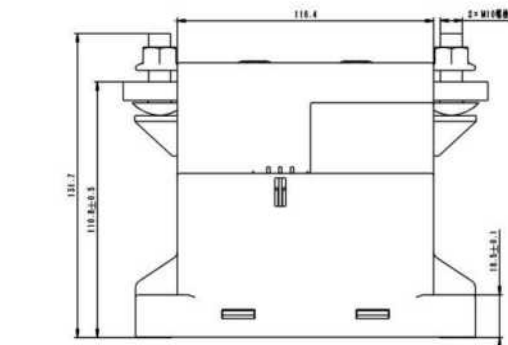

接线图  
Coil Wiring Diagram

未注公差 General Tolerance:  
 < 10mm: ± 0.3mm  
 10-50mm: ± 0.5mm  
 > 50mm: ± 0.8mm

外形尺寸图 OUTLINE DIMENSIONS

HCF1000A/□-□-HC3

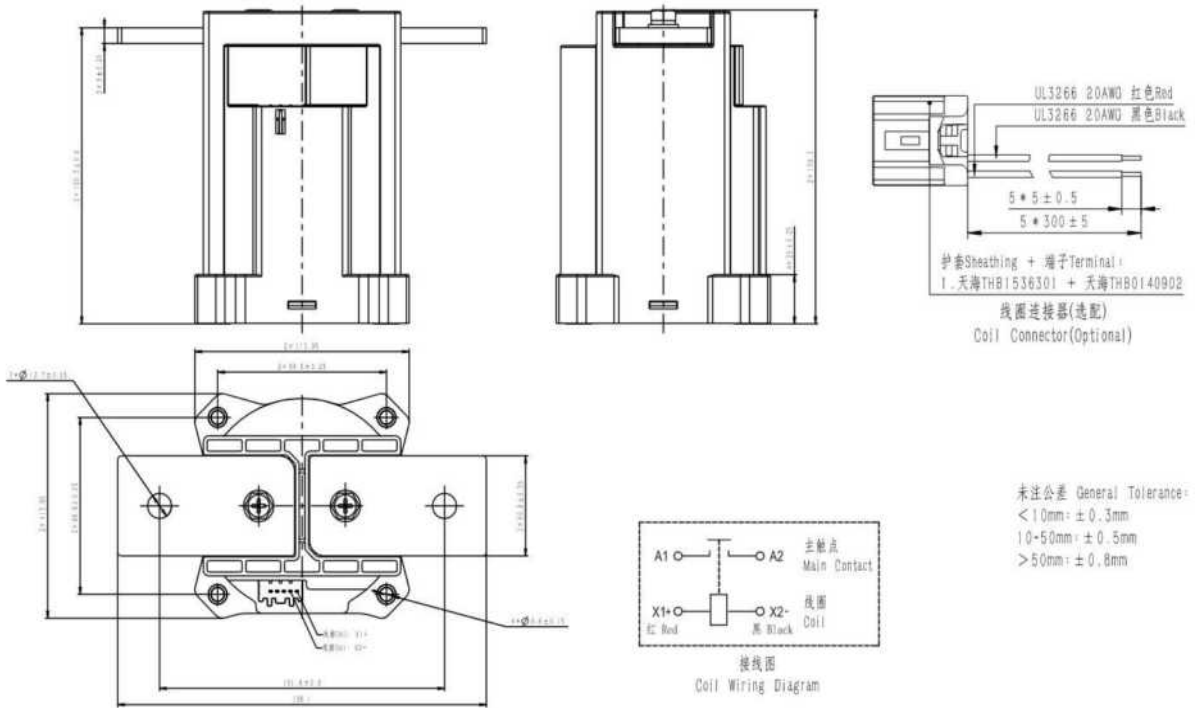

HCF1000A/□-□-HC3Z

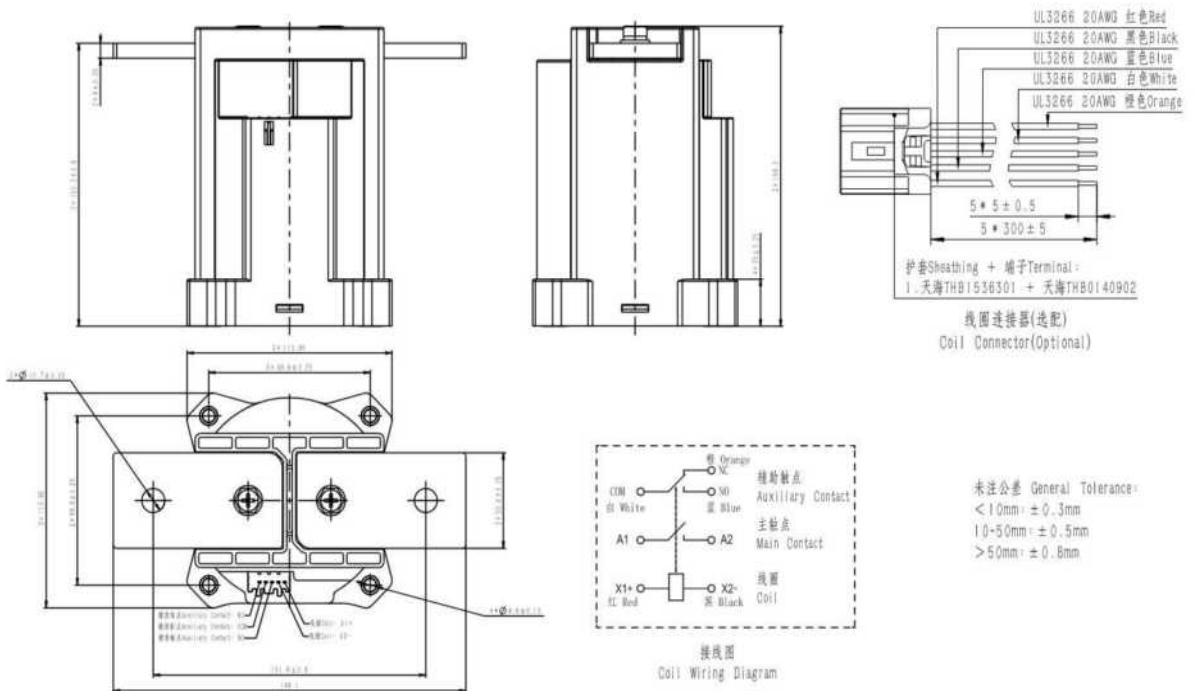

外形尺寸图 OUTLINE DIMENSIONS

HCF1000B/□-□-HC3

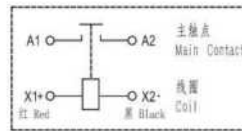
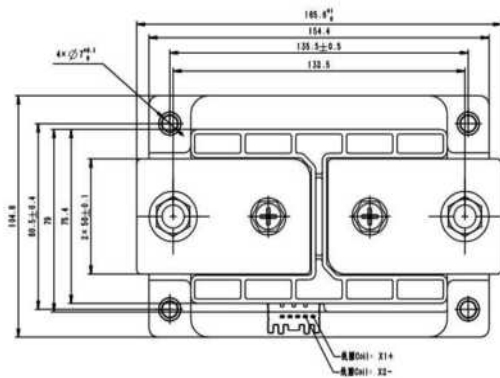
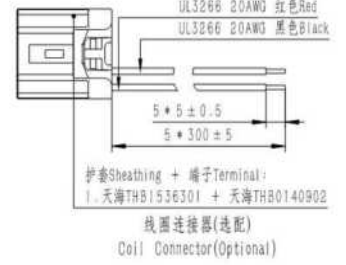
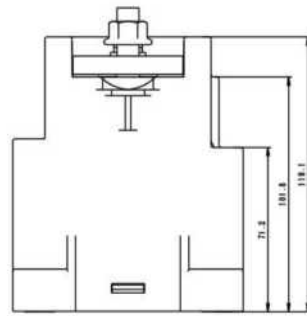
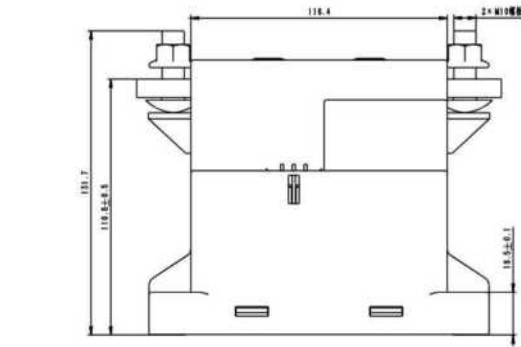

接线图  
Coil Wiring Diagram

未注公差 General Tolerance:  
 < 10mm: ± 0.3mm  
 10-50mm: ± 0.5mm  
 > 50mm: ± 0.8mm

HCF1000B/□-□-HC3Z

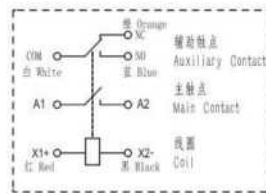
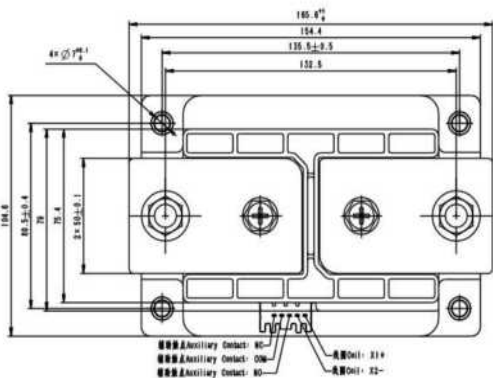
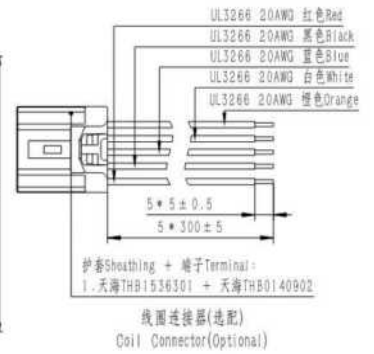
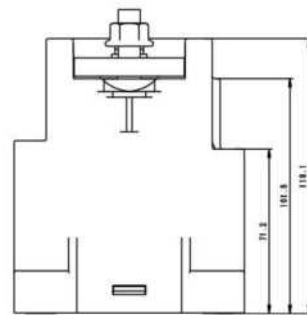
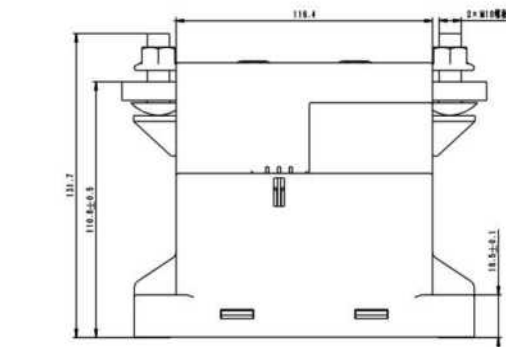

接线图  
Coil Wiring Diagram

未注公差 General Tolerance:  
 < 10mm: ± 0.3mm  
 10-50mm: ± 0.5mm  
 > 50mm: ± 0.8mm

# 使用注意事项 CAUTIONS

1. 请避免安装在强磁场（变压器、磁铁周围）或发热物体附近。  
Please avoid installing in strong magnetic fields (transformers, magnets around) or hot objects.
2. 使用环境温度-40°C~+85°C, 湿度5%~85%RH。  
Use the environment temperature -40°C~+85°C, humidity 5%~85%RH.
3. 电寿命试验在L/R≤1ms条件下进行。  
Electrical life test under L/R ≤1ms condition.
4. 当接触器的线圈和触头有极性时, 在进行线圈和触头的连接时, 请按接线图的指示进行操作。  
When the coil and contact of the contactors have polarity, connect the coil and contact according to the instructions of the wiring diagram.
5. 请注意: 若线圈并联二极管使用, 接触器释放时间会加长, 造成电寿命降低。  
Please be atention: If parallel diode on coil will increase contactors release time and decrease electrical life.
6. HCF250C/250E/350/400/400B/500/500B/600/700/800/1000系列接触器内置单触发脉冲发生电路, 请通过快速上升(脉冲式供电方式)驱动线圈; 接触器接通信号后, 约300ms后线圈电流自动切换, 请避免间隔不满300ms的重复切换操作。  
HCF250C/250E/350/400/400B/500/500B/600/700/800/1000 series contactors have a built-in one-shot pulse generator circuit, please drive the coil with a quick startup (pulse power supply mode); after the signal enters contactors, automatic coil curent switching occurs after approximately 300ms, please avoid repetitive switch in which interval time is less than 300ms.
7. 请避免在引出端上粘附油脂等异物, 建议使用下表推荐规格导线, 否则有可能造成引出端异常发热。  
Please avoid the adhesion of oil and other foreign material on the lead sheet, it is recommended to use wires of the recommended specifications in the table below, otherwise it may cause the abnormal fever in the lead-out part.

电流等级 (A) Current rating (A)	40A	60A	100A	150A	200A	250A	300A	400A	500A	600A	700A	800A	1000A
公称截面积 (mm <sup>2</sup> ) Nominal area (mm <sup>2</sup> )	≥10	≥16	≥35	≥50	≥60	≥100	≥100	≥150	≥200	≥400	≥400	≥400	≥480

8. 为防止出现松动, 接触器安装时请使用垫圈螺钉锁紧, 各部位的螺钉锁紧扭矩和开孔尺寸请控制在以下范围:  
In order to prevent loosening, please use the washer screw to lock when the contactors is installed, the screw locking torque of each part and hole size should be controlled in the following range:

继电器壳体安装部位 relay shell installation department			主负载安装部位 main loading installation part	
螺钉型 screw type	扭力 twisting for	底板建议开孔尺 recommended hole size for	螺钉型 screw type	扭力 twisting for
M4	1.8-2.8N.m	Ø 4.5mm	M4	1.8-2.8N.m
M5	3-4N.m	Ø 5.5mm	M5	3-4N.m
M6	6-8N.m	Ø 6.5mm	M6	6-8N.m
			M8 (螺母Nut)	9-10N.m

9. 螺钉安装时, 螺纹咬合深度不能过浅, 否则有可能导致滑牙松脱, 建议咬合深度至少螺纹深度的2/3。  
When screw installation, depth of match should not be too shallow, otherwise may lead to screw loose, recommend 2/3 of length of thread at least.

10. 接触器安装底板倒角外圆大小不宜过大, 否则安装时接触器安装衬套易松动, 请参考图1:  
Contactors installation baseboard hole can't be chamfered too much, otherwise contactors shell bushes will loose, please refer to figure 1:

11. 当接触器使用1个及多个导电铜排连接时, 请确保导电铜排与触点端面紧密贴合(多个铜排需确保大电流的导电铜排最贴近触点端面, 小电流的导电铜排其次), 然后是平垫圈、弹簧垫圈、螺母。不正确的连接顺序可能造成严重过热, 请参考图2:

When contactors is connected with one or more busbars, please ensure that the busbars are tightly fitted to the contact terminal face (when there are multiple busbars, please ensure that the busbar with large current is closest to the contact terminal face, and the busbars with low current come next), then the flat washer, spring washer and screw. Incorrect connection order can cause severe overheating, please refer to figure 2:



图 1(Fig 1)

图 2(Fig 2)

# 致力于成为世界一流的新能源电气解决方案供应商

We are committed to becoming a world-class supplier of new energy electrical solution

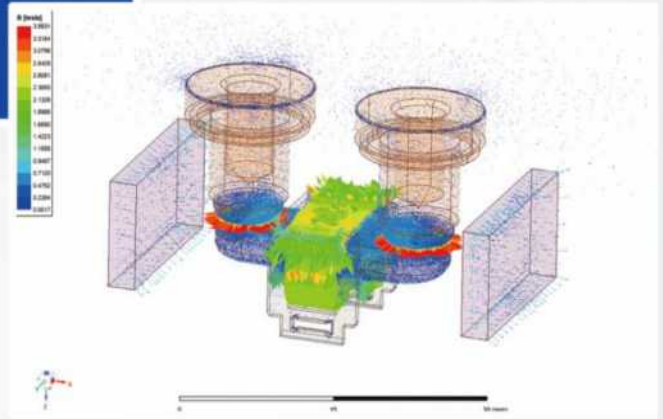
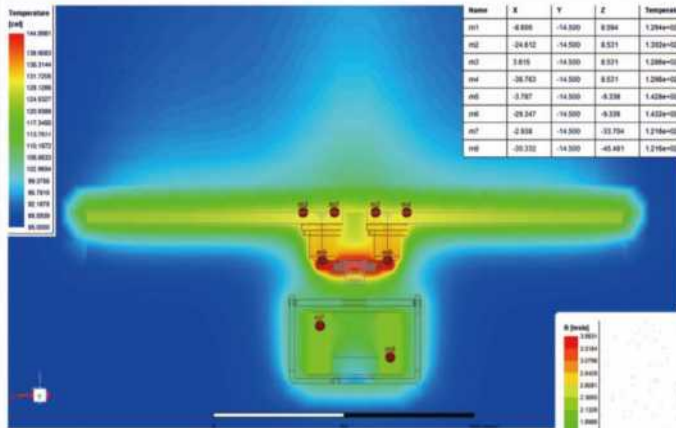





HIITIO<sup>®</sup>  
和诚电气



ISO9001 CERTIFIED



ISO14001 CERTIFIED



ISO45001 CERTIFIED



IATF16949 CERTIFIED



浙江和诚智能电气有限公司

ZHEJIANG HECHENG SMART ELECTRIC CO., LTD.

浙江省杭州市萧山区经济技术开发区  
桥南区知行路1125号

No.1125 Zhixing Road, Qiaonan District, Xiaoshan  
Economic and Technological Development Zone,  
Hangzhou, Zhejiang

T 400-667-9977

E support@hiitio.com

w www.hecheng.com.cn

www.hiitio.com

©浙江和诚智能电气有限公司版权所有  
出版日期：2024年